

The Comprehensive Economic
Development Strategy (CEDS)
FY 2019-2023



Region III Planning and Development Council
Serving Boone, Clay, Kanawha and Putnam Counties

315 D Street
South Charleston, WV 25303
(304) 744-4258

June 2019

INDEX

	Page
Introduction.....	3
Summary Background.....	8
Boone.....	18
Clay.....	31
Kanawha.....	42
Putnam.....	56
SWOT Analysis.....	67
Strengths.....	70
Weaknesses.....	75
Opportunities.....	76
Threats.....	78
Strategic Direction / Action Plan.....	80
Evaluation Framework.....	85
Economic Resilience.....	87
Regional Economic Analysis.....	89
Regional & County Initiatives Project List.....	98
RIC Progress Report.....	105
Appendix.....	113

Introduction

This report constitutes the Comprehensive Economic Development Strategy (CEDS) for West Virginia Region III, which consists of Boone, Clay, Kanawha and Putnam Counties. It is developed by the Regional Intergovernmental Council (RIC) with the support of US EDA and in collaboration with the CEDS committee and local economic development agencies.

The purpose of the CEDS is to provide an overview and analysis of current economic conditions and a future vision for the region. This vision is expressed as goals, objectives and strategies. Specific projects are also proposed.

Region III has not escaped the impact of the recent economic downturn and is affected by the changing national and global economy. Like much of West Virginia, the area is blessed with rich natural resources and the advantages, such as proximity to eastern markets. The primary challenge for the future is to use these advantages to develop and sustain a robust economy.



The interstate highway system that serves Region III includes I-64, I-77 and I-79. This interstate system has largely been responsible for Region III's growth as a major distribution center. The river, rail, air, and highway network has been a stimulus to all sectors of the economy and allows Region III ease of trade with all other areas in the nation. Appalachian Corridor G connects southern West Virginia (Boone-Logan) with the Interstates in Charleston.

Coal remains relevant to the regional economy; however, Region III, along with the rest of the State of West Virginia, continues to experience the negative impact of the once thriving, coal industry. The economy is noticing a transition: mined out Appalachian coal operations are fading, while the new Marcellus gas industry is thriving. In addition, the Region lies within the Central Hardwood Forest areas and is predominantly forested – forests occupy nearly 80% of the land surface.

In addition to struggling with the loss of coal jobs, Region III is also currently facing an opioid epidemic. According to a study by the American Enterprise Institute the opioid epidemic is costing Boone County's economy an estimated \$206.5 million a year, which is the highest per-capita burden of any county in the United States. On a total cost (not per-capita) the opioid epidemic is costing Kanawha County's economy \$854 million each year. The opioid epidemic is placing a strain on the local economies.

Water and sewer infrastructure, broadband infrastructure, and technology remain very important to our region. Region III serves Boone, Clay, Kanawha and Putnam counties and continues to provide technical assistance, project development and project administration to each county. Water and sewer infrastructure development is vital as these services are needed to enhance our region's economic opportunities. Implementation of broadband to our rural areas will be crucial in making existing and future business owners more competitive in state, national and global markets.

With the help of the CEDS Committee, the Region III staff created the Comprehensive Economic Development Strategy for fiscal years 2019 – 2023 to address the needs of the region by strengthening and diversifying the economy and creating economic resiliency throughout Region III.

History of the Regional Intergovernmental Council

The Regional Intergovernmental Council (RIC) was established in 1968 as a voluntary organization of the local elected municipal and county officials in Boone, Clay, Kanawha and Putnam counties. It was the first regional planning and development council in the State of West Virginia. The purpose of RIC was to address regional issues and promote intergovernmental cooperation.

The West Virginia Legislature enacted the *West Virginia Regional Planning and Development Act* in 1971. This act divided the state into eleven regions, each of which serves as a development district for its respective member counties. The goal of the act was to more effectively utilize the State's resources and to maximize the opportunities for local communities and public service agencies to secure federal assistance for economic development, water and sewer systems, and other public projects.

Governor Arch A. Moore Jr. designated RIC as the transportation planning agency for the urbanized area within Boone, Clay, Kanawha and Putnam counties on July 1, 1974. Metropolitan Planning Organizations (MPOs) are created by Federal law with the responsibility to develop the area's transportation plans and to coordinate the transportation planning process.

The MPO planning process includes making informed predictions and recommendations about future transportation needs. The information generated by this process is used by decision-makers to select transportation policies and programs for the region. RIC conducts regular meetings with a technical advisory committee and a bicycle and pedestrian committee.

RIC is structured as a locally oriented public corporation. It is directed by elected municipal and county officials from within its jurisdiction, as well as non-elected appointees from a cross-section of the region's social and economic institutions. RIC's policy board consists of 48 members, including one commissioner from each of the four counties, the mayor of each of the 25 municipalities, seventeen citizen representatives and two minority representatives.

Within the RIC Region III Planning and Development Council

<i>COMMUNITY</i>	<i>REPRESENTATIVE</i>
Boone County Commission	Eddie Hendricks
Clay County Commission	Connie Kinder
Kanawha County Commission	W. Kent Carper
Putnam County Commission	Andy Skidmore
Town of Bancroft	Donna McKneely
Town of Belle	David Fletcher
Town of Buffalo	Conrad Cain
Town of Cedar Grove	James B. Hudnall
City of Charleston	Amy Goodwin
Town of Chesapeake	Janet Armentrout
Town of Clay	Jason Hubbard
Town of Clendenin	Shana Clendenin
Town of Danville	Mark McClure
City of Dunbar	William E. Cunningham
Town of East Bank	Charles A. Blair, II
Town of Eleanor	Cam Clendenin
Town of Glasgow	Donald Fannin
Town of Handley	Essie Ford, Jr.
City of Hurricane	Scott Edwards
City of Madison	Sonny Howell
Town of Marmet	Jay Snodgrass
City of Nitro	Dave Casebolt
Town of Poca	William Jones
Town of Pratt	Eric Holcomb
City of St. Albans	Scott James
City of South Charleston	Frank Mullens
Town of Sylvester	Manuel Arvon
Town of Whitesville	Fred V. Harless, Jr.
City of Winfield	Randy Barrett
Boone County Citizens Representative	Kris Mitchell
Clay County Citizens Representative	David Pierson, Jr.
Kanawha County Citizens Representative	John Luoni
Putnam County Citizens Representative	Mark A. Stolle, Jr.
City of Charleston Citizens Representative	Dennis Strawn
RIC Minority Representative	Oree Banks
RIC Minority Representative	Coston Davis, Jr.
Private Sector Representative (Education)	Heather Raines, BridgeValley CTC
Private Sector Representative	Joy Underwood, Coal River Inn
Private Sector Representative (Workforce Development)	S.K. Miller, Verizon Mid-Atlantic (Retired)
Private Sector Representative (Labor)	Todd Mullins, Kanawha Valley Labor Council
Private Sector Representative (Chamber of Commerce)	Jeri Adkins, Charleston Area Alliance
Private Sector Representative (WVDOH)	Perry Keller, WV Department of Transportation
Private Sector Representative (KVRTA)	Doug Hartley, KVRTA
Private Sector Representative	Damron Bradshaw, Bradshaw Consulting Services
Private Sector Representative	Eric Sharp, Labor Employees Coop. Trust
Private Sector Representative	Trina D. Sweeney, WV State University
Private Sector Representative	D. Anne Cavalier, Cavalier Business Development
Private Sector Representative	Lee Roberts, Tornado Products

RIC Region III Staff

Executive Director

Colt Sandoro

Deputy Executive Director

Amy Talbert

Administrative Assistant

Joanna Keller

Planning Director

Kara Greathouse

Transportation Planner

Kelsey Tucker

Transportation Planner

Samuel Richardson

Project Administrator

SoJuana Ellis

Project Coordinator

Terry Martin

Summary Background Within the Region



YEAGER AIRPORT

In July 2018, Governor Justice presented Yeager Airport with a check for \$3 million in state matching funds that is being used to leverage \$30 million in federal construction funds for improvements at Yeager Airport.

The Airport held a ground-breaking ceremony on October 24, 2018 for a \$4.1 million road expansion project in the general aviation area of the the airport. They received a \$3.7 million grant from the Federal Aviation Administration's Airport Improvement Program to be used for the road expansion, including utility duct banks. Extending the access road allows the airport to access and develop a 25-acre business park and provide the 130th Airlift Wing with a second secure access route to and from the Air National Guard base. This infrastructure project will open land at Yeager Airport for a proposed Marshall University flight school and aviation education center, as well as, a possible site for an air cargo operation and new corporate aviation hangars. Yeager Airport is also receiving \$1.4 million dollars through the Federal Aviation Administration's Airport Improvement Program to be used for security enhancements. The security enhancements will include new cameras, perimeter security that includes fencing and access control improvements, and an additional police vehicle.



Planned Marshall University Aviation Education Center and Flight School at Yeager Airport

Yeager Airport also received a \$3.5 million discretionary grant from the Federal Aviation Administration to fund a solar energy project. More than 1,800 solar modules are being installed on top of one of the airport parking garages. The solar modules will generate enough power to supply both parking garages. A second and third phase solar installation is also being planned. If phase two and phase three components are completed as planned, the solar power they generate will be metered into the power grid, with the airport receiving enough credit for the energy it contributes to cover the \$250,000 annual cost for power. This would lead to Yeager Airport becoming the first airport in the nation to supply its own power needs.

In addition, Yeager Airport is also getting two new restaurants and a gift shop. Faber Coe and Gregg Inc. has started \$300,000 worth of renovations. The Java Moon restaurant will be placed in the pre-security area of the airport and will hopefully attract people from downtown and the surrounding community. The second restaurant will be called The Junction Charleston and will be in the post-security area of the airport.

Yeager Airport is critical to the area economy with an annual economic impact of \$174,662,309, adding 1,876 full time equivalent jobs and 425,000 passengers served annually. The new development at Yeager Airport will lead to additional job creation and future investment opportunities.



Toyota Motor Manufacturing, West Virginia announced on March 14, 2019 that Toyota is investing \$111 million in the Buffalo, WV plant. The investment will bring 123 new jobs to the facility and includes a building expansion and equipment to double capacity of hybrid transaxles from 120,000 units to 240,000 annually. According to Leah Curry, President of Toyota Manufacturing West Virginia, doubling the

production of hybrid transaxles in West Virginia solidifies the Buffalo plant's role in producing next generation engines and transmissions that will drive the future of Toyota's advanced mobility technology. This new investment builds on the \$115.3 million expansion announcement at the plant in 2017. Overall, the Buffalo plant now represents a \$1.4 billion investment and is directly responsible for 1,600 good-paying jobs.



Charleston
Coliseum



The Charleston Coliseum & Convention Center held a ribbon-cutting ceremony for the grand reopening on October 19, 2018 for the \$100 million renovation and expansion project that began in June 2015. Along with receiving massive upgrades, the arena also received a new name that was more fitting for the facility that is an arena for large entertainment events and a modern, state-of-the-art convention and meeting facility designed to service the meeting industry. The Charleston Coliseum & Convention Center has a completely redesigned entrance and lobby, expanded and additional meeting space with high ceilings and a new ballroom. Other interior upgrades include new carpet, tile and granite countertops; a catering kitchen, digital way-finding stations, functional public spaces, a refurbished exhibit space, loading docks and Wi-Fi access. The touch-screen way finding stations present guests with a map of the facility and a list of what is happening at each location. All twenty-five meeting rooms have state-of-the-art audio/visual equipment and a digital screen outside of the door displaying which group has the room reserved, which is interconnected with the facility's booking software. The new catering kitchen is four times the size of the old kitchen and there was 25,000 square feet added to the ballroom, which can now seat up to 1,400 people. There is also an outdoor space for cocktail parties and artwork. The facility is now completely computer controlled for functions like lighting, heating and air conditioning along with lighting and sound system upgrades added to the coliseum. The renovation and expansion project were financed through a Tax Increment Financing (TIF) district and a half-percent sales tax and will help attract more conventions to the city and bring in more tourism and economic growth to the region.

The logo for West Virginia Regional Technology Park features a stylized blue circular emblem composed of overlapping lines, resembling a globe or a molecular structure. To the right of the emblem, the text "WEST VIRGINIA REGIONAL TECHNOLOGY PARK" is displayed in a serif font, with "WEST VIRGINIA REGIONAL" in a smaller size above "TECHNOLOGY PARK".

WEST VIRGINIA REGIONAL TECHNOLOGY PARK



The West Virginia Regional Technology Park (WVRTP) in South Charleston continues to add tenants to its massive grounds. The WVRTP is a multi-tenant facility with a commitment to innovation, technological advancement and education. The WVRTP is an ideal location for technology-based companies interested in expansion, new businesses requiring research and laboratory space, and technology-based and research-oriented educational institutions. The West Virginia Regional Technology Park is the ideal location to transform an abstract idea into a completed, market-ready project. Starting with conveniently located office space and the capacity for state-of-the-art laboratory space, new concepts, technologies or systems can be created and refined. Through utilization of available scale-up pilot plants, continued research and testing can be conducted on-site. The WVRTP's ability to provide small-scale manufacturing capabilities allows for production that is both cost and time efficient. The opportunity to seamlessly transition from bench-top to production in one location increases the likelihood of success for both startups and established companies.

The State of West Virginia accepted the park as a gift from The Dow Chemical Company and December 15, 2018, marked the eighth anniversary of the park. The WVRTP has a rich history of innovation and is home to more than 30,000 patented discoveries, valued at approximately \$18 billion. Spanning 258 acres with existing infrastructure comprised of 950,000 square feet of laboratories, chemical pilot plant facilities, engineering and data processing capabilities, the WVRTP enables companies to share and benefit from an established environment of discovery, innovation and success.



BridgeValley Community and Technical College is also located at the WVRTP and grants more than 20 Associate in Applied Science Degrees, one Associate in Science Degree, one Associate in Arts Degree, 17 Certificate of Applied Science Degrees, and twelve Skill Sets. To meet the expressed need for nurses in the region, the college also began an Associate Degree program for nursing.

BridgeValley Community and Technical College is the recipient of a \$749,000 grant from the U.S. Department of Commerce's Economic Development Administration, matching a previous POWER grant from the Appalachian Regional Commission for a total of \$1.5 million to develop a training center that will administer programs to meet the needs of the community impacted by the declining use of coal. The funds are awarded through the Economic Development Administration's Assistance to Coal Communities program. The funding will be used to establish the Workforce Construction, Telecommunication and Energy Training Center in Montgomery and along with BridgeValley's Advanced Technology Center in South Charleston, to support BridgeValley's Horizontal Directional Drilling, expanded Utility Line Service, Heavy Equipment, Commercial Driver's License, Data and Fiber Cabling, expanded Gas Measurements and HVAC, Building Automation and Energy Management programs. The new training center will provide job-based skills training in various trades based on the needs of the industry in this region. The Workforce Construction, Telecommunication and Energy Training Center is expected to train and place more than 200 trainees within the first three years of operation, and up to 1,836 trainees in the first nine years.



Development of the Hatfield-McCoy Trails system will begin progressing soon. The Ivy Branch trail system located within 20 miles of Charleston, off of U.S. 119 is expected to reopen in the summer of 2020, thanks to a \$1.3 million grant from the Federal Highway Administration's Transportation Alternative and Recreation Trail program and a \$1.5 million grant from the WVDEP's Office of Abandoned Mine Lands for the Ivy Branch Off Road Park Phase II project. This project will include construction of cabins, master planning and development of a river access site on the Coal River. An added benefit to reopening the Ivy Branch Trail will be the creation of a put-in point for kayaks and canoes on the Little Coal River. The Ivy Branch trail system is expected to be far more than just a place to go trail riding, it is expected to be a recreational playground. A \$120,000 grant from the Transportation Alternative and Recreational Trails fund was also awarded to the Hatfield-McCoy Trails to identify sites and begin building 100 miles of new trail in Boone County.

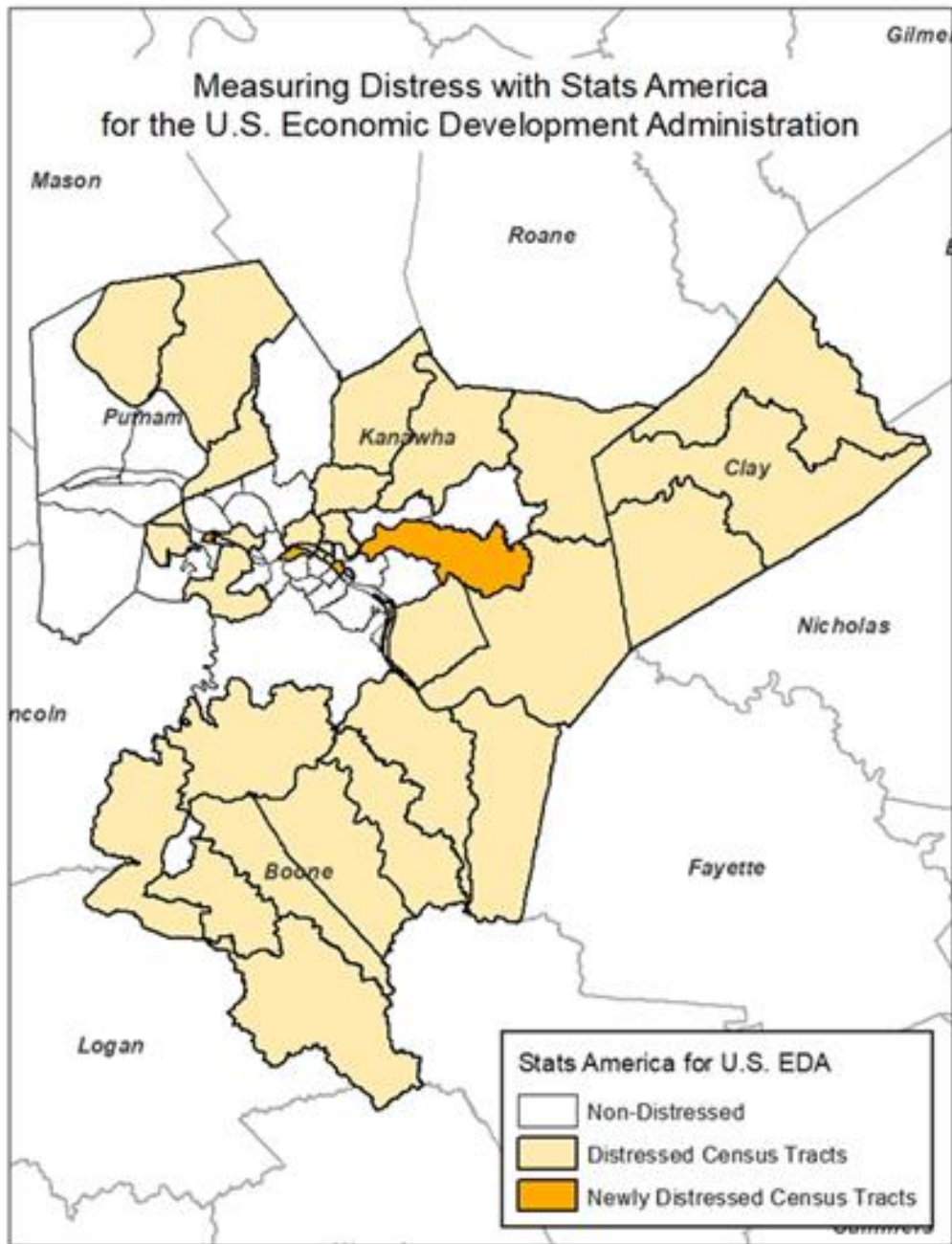

Low energy prices and declining coal production have hurt the economy in West Virginia. The steady decline in coal production has been followed by the closing of many mines within the region resulting in a significant amount of job layoffs. The region continues to be negatively impacted by the downward trend of the coal industry. Innovative and entrepreneurial ideas are what economists are saying could bring the state of West Virginia some form of relief and ultimately, growth.

The POWER (Partnerships for Opportunity and Workforce and Economic Revitalization) is comprised of multiple agencies and continues its' primary focus on assisting regions and communities that have been directly impacted by coal-related losses. Federal resources are obtained to help these affected areas to promote economic re-growth, enhance diversity, and accentuate alternative job training in hopes of developing opportunities for reemployment.

Since 2015, ARC has awarded \$148 million through the POWER Initiative to help coal-impacted communities in 312 Appalachian counties diversify and grow their economies. These 185 project investments are projected to create or retain almost 17,500 jobs, create or improve more than 7,200 businesses, leverage an additional \$772 million in investment, and prepare thousands of workers and students with globally competitive skills and opportunities in the Region's manufacturing, technology, entrepreneurship, agriculture, and other emerging sectors.

2019 POWER Grant Award Summaries:

\$1,020,556 ARC grant to the West Virginia Food & Farm Coalition in Charleston, WV, for the Geographic Food and Agriculture Systems Development project. The project will provide coordination, capacity building, training, and technical assistance to enable farmers, food businesses, and community members to determine and execute agribusiness priorities. This will result in increased food production and access to previously unreachable markets, thereby creating greater economic diversity for areas that have been heavily impacted by the decline in coal production. The project will deploy seed capital, in the form of mini grants, to attract private dollars and execute larger-scale projects that strengthen the local food system. The West Virginia Food & Farm Coalition will strengthen the local food supply chain, increase market opportunities for local growers, including more than 75 food-related entrepreneurs, and attract private investment in five foodsheds that span seventeen coal-impacted counties of West Virginia. Additional funding for the project is provided by the Mary Reynolds Babcock Foundation and the Greater Kanawha Valley Foundation.

\$1,000,000 ARC grant to the WV Community Development Hub (The Hub) in Charleston, WV, for the Mountain State Capital: Filling the Critical Venture Capital Gap in West Virginia project. The project will support the development of a new venture capital (VC) fund to support high-growth startups in Central Appalachia. The fund will be a partnership between The Hub and Mountain State Capital (MSC). It seeks to boost entrepreneurial activities and grow capital investment by supporting the creation of the first seed-stage venture capital investment fund serving West Virginia and Central Appalachia. MSC will fill a critical gap in the state's entrepreneurial ecosystem, providing coaching, technical assistance support, and VC investment funds to business startups. MSC and The Hub, as a

community-driven institutional investor, will target West Virginia-based startups during the first phase of the investment cycle. All revenue generated by the initial investment will be directed to a dedicated technical assistance fund to support community development across West Virginia, with particular priority given to coal-impacted rural communities. The success of these business startups will then provide long term investment return to MSC and The Hub and enable the expansion of their technical assistance grants to support community development, entrepreneurial learning, and business development products across the state.

\$100,000 ARC grant to the Center for Rural Health Development in Hurricane, WV, for the Creating a More Vibrant Economy for Coal-Impacted Counties in West Virginia project. The project will provide technical assistance for the development of a Community Health Improvement Plan in each of five targeted distressed West Virginia counties (Calhoun, Logan, McDowell, Roane, and Webster). Each plan will be developed by a cross-sector partnership involving government agencies, private businesses, education, economic development organizations, health care organizations, and residents in each county. The project will build capacity through a model of change that was developed by the Centers for Disease Control and Prevention (CDC) and the National Association of County and City Health Officials (NACCHO). The project aims to create a culture of health which will help prevent future opioid use and help stymie expansion of the current opioid crisis. Financial partners include the Claude Worthington Benedum Foundation, the Logan Healthcare Foundation, and the Sisters of Health Foundation.

\$80,691 ARC grant to the Women's Institute for a Secure Retirement (WISER) in Washington, D.C., for Benefit U: An Entrepreneur's Guide to Financial, Health Insurance, and Retirement Solutions. Targeting five distressed counties in West Virginia (Boone, Logan, McDowell, Mingo, and Wyoming), WISER will develop Benefit U to serve as a virtual human relations department for entrepreneurs, self-employed workers, independent contractors, and other workers without access to benefits resources. Benefit U will include paycheck guidance, income tax assistance programs, health insurance navigators, emergency and long-term savings advice, and financial education and retirement planning tools.

\$79,270 ARC grant to the Marshall University Research Corporation, in Huntington, WV for the Craft Beer and Spirit Trail project. The project will conduct an economic impact study of the emerging craft beer and spirits industry in central and western West Virginia counties (Cabell, Kanawha, Putnam, and Roane). The study will identify emerging strengths, existing leakages, and new business and employment opportunities to guide local economic development leaders. Project activities will include asset mapping, leakage monitoring, and guidance to establish a road map for building local efforts into a cohesive

regional program for the craft beer and spirits trail. Key partners include the WV Department of Tourism, Putnam County Economic Development Authority, Huntington Area Development Corporation, Huntington Regional Chamber of Commerce, and the Charleston Area Alliance.

\$59,500 ARC grant to the New River Gorge Trail Alliance (NRGTA) in Fayetteville, WV, for the Linking Trails and Communities to Spawn Economic Growth and Wellness: Expanding the Southern West Virginia Bike Trail Network project. The project will guide the expansion of the current regional trail network to add five counties: Kanawha, Monroe, Raleigh, Summers, and Webster. Key partners include the Rails to Trails Conservancy, WV Division of Highways, Region 4 Planning and Development Council, and the National Park Service. The project will support community engagement for trail towns, trail vision mapping, capacity building for local trail organizations, and trail mapping, which includes rail corridor and road inventory, rail and trail assessment, and trail feasibility efforts. The trail planning documents will serve as a comprehensive roadmap for communities to transform an unused railroad corridor or other areas into a dynamic multi-use trail and will produce trail town toolkits to benefit all eight counties along the trail.

BOONE COUNTY



Walhonde Water Trail

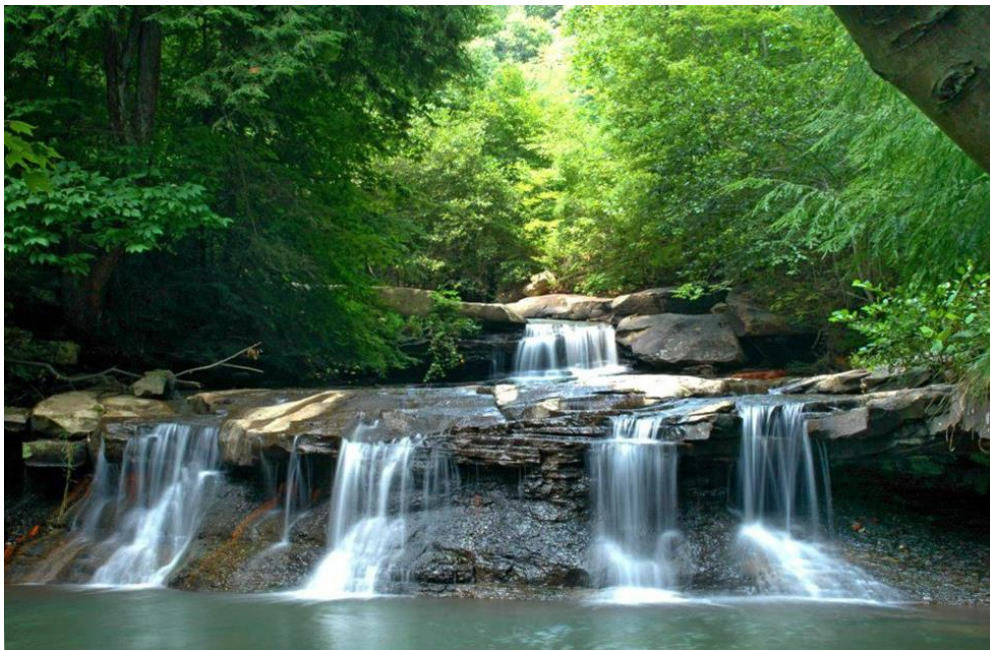

Drawdy Falls in Paytona

Boone County was formed in 1847 from portions of Kanawha, Cabell, and Logan counties, Virginia. The County was named for Daniel Boone, a noted hunter and explorer, who made his home in the Great Kanawha Valley from 1788 to 1795. Located in southwestern West Virginia, Boone County borders Kanawha, Lincoln, Logan, Wyoming and Raleigh counties. Madison is the county seat, with three other municipalities of Danville, Whitesville and Sylvester, nearby. The Madison/Danville area of Boone County is approximately 37 miles south of Charleston. The county area is 503 square miles and lies in the Appalachian Plateau. Most of the area is divided by streams and water courses, which give the region the appearance of an endless formation of hills and contrasting valleys. The average temperature in Boone County is 54 degrees with the annual snowfall ranging from 25 to 35 inches.

Distance to Major Cities from Madison

Atlanta.....	517 miles
Chicago.....	512 miles
Cincinnati.....	222 miles
Cleveland.....	281 miles
Columbus.....	241 miles
Lexington.....	181 miles
New York.....	560 miles
Pittsburgh.....	257 miles
Washington, DC.....	391 miles

Economy

Boone County is an area that has relied and thrived primarily on coal production and continues to struggle after the closure of several mines in the area. Boone County is diversifying with job opportunities being created outside of the coal industry. The completion of Appalachian Corridor G through Boone County promotes residential and commercial development. The Boone Partners in Development and Boone Memorial Hospital developed a walking and biking trail for the Madison/Danville area. This trail has been designed to promote wellness in the county.

Tourism also brings business opportunities to Boone County, the county’s 70-mile section of the Hatfield-McCoy Recreational Trails offer outdoor recreational opportunities to off-road enthusiasts, including ATV riders and motorcyclists.

Despite these initiatives, the Boone County economy is still heavily dependent on the coal industry. Thus, it is vulnerable to cyclical changes in the price and demand for coal. Unfortunately, the downturn of coal has highlighted the need to identify new opportunities for economic growth.

In addition to struggling with the loss of coal jobs, Boone County is also facing an opioid epidemic that is costing the economy an estimated \$206.5 million a year. According to a report by the American Enterprise Institute this is the highest per-capita burden of any county in the United States.

TRANSPORTATION

Highways

One U.S. and two state highways serve Boone County. Providing service to Madison and Danville is U. S. 119 (Corridor G) which connects with Charleston, West Virginia and the State of Pennsylvania to the northeast and with Logan and Williamson, West Virginia and the State of Kentucky to the south.

Public Transportation

Tri-River Transit in Hamlin, Lincoln County, provides limited local transit service in Boone County. Routes include Clothier to Madison and Wharton to Madison. The Boone County community organization provides various transportation services for senior services.

Rail Service

The CSX system supplies freight service to the communities of Boone County.

Air Service

The nearest commercial airport is Yeager Airport at Charleston, a distance of 37 miles.

UTILILTIES

Water

Boone County PSD supplies water to Madison and Danville and the major portion of Boone County. Much of the water is supplied by the WV-American Water Company through public-private partnership.

Electric

American Electric Power (AEP) provides electric power throughout Boone County.

Gas and Other

Natural gas is supplied by Ashford Gas, Southern Public Service District, Pennzoil and Hope Natural Gas, Inc. Coal, fuel oil and propane are readily available from local suppliers.

The following "Quality of Life" facts exist in Boone County:

- Low Crime Rate
- County-wide 911 Service and Ambulance Service
- 8 Fully equipped Volunteer Fire Departments
- Ready and Willing Labor Force
- Excellent School Facilities
- Educational/Vocational Development
- Workforce Training at Southern WV Community College
- Two National Blue-Ribbon Schools
- Three WV Schools of Excellence
- Truck Driving Academy (95% Job Placement Rate)
- Hatfield-McCoy Trail Visitor's Center
- Fully Staffed Hospital in Madison
- Nursing and Rehabilitation Center
- Housing Complexes for Seniors and the Elderly
- Public Libraries in Madison, Whitesville, Wharton and Racine
- Public Transportation
- 8 Community and Recreational Centers
- Waterways Park (West Virginia's Water Park)
- County and Municipal Parks and Pools
- Fishing and Hunting Facilities
- National Mine Disasters Memorial
- National Historic District at Nellis
- Coal Heritage Museum in Madison
- County Courthouse on National Register of Historic Places
- Annual Festivals in Madison, Danville, Whitesville & Sylvester
- County-Wide Water Project
- Miles of Beautiful Scenic Trails for Outdoor Recreational Use
- Four-Lane Highway Access
- Thirty-Minute Drive to State Capitol
- Rail and Motor Carrier Freight Service
- 3-Mile Walking Trail in Madison to Promote Wellness

Big Coal River Outpost Opens in Rumble



The Big Coal River Outpost is a new business that Jeff and Samantha Petry opened in Rumble that will help to boost tourism in the area. They provide a 'grab and go' kayak rental services for the Coal River Watershed and Walhonde Water Trail. They offer a variety of styles of kayaks based on the paddlers needs. All rentals include paddle, lifejacket and a quick demo on paddling techniques and things to look for on the water. They also offer a shuttle service for groups of people who want to enjoy the river together.

Stevenson LLC, Day Habilitation and Pre-Vocational Facility Opens



Stevenson LLC is a day habilitation and pre-vocational center that serves clients with intellectual and developmental disabilities in Boone and surrounding counties. Their mission to provide the best, least restrictive, most effective and economical person-centered services to individuals and families. The 5,000-square-foot facility located on Main Street includes multiple classrooms, a library, fitness room, arts and crafts room and a computer lab.

Madison VFD receives grant of more than \$500K



The Madison Volunteer Fire Department received a \$519,534 grant from the U.S. Department of Homeland Security's Federal Emergency Management Agency. The funding comes through FEMA's Assistance to Firefighters Grant (AFG) and Staffing for Adequate Fire and Emergency Response (SAFER) programs and will assist the fire department with the purchase of equipment.

Rusted Roots Salon Opens in Danville



Rusted Roots, a full-service salon owned by Shelbee Thompson is now opened for business in downtown Danville. The salon is located at 646 Phipps Avenue in a renovated building with beautiful antique hardwood floors and partially exposed brick walls. In the beginning, Rusted Roots will be doing hair and makeup, but plans to expand their services to include nails, facials, massages and tanning. Salon owner Shelbee Thompson attended Paul Mitchell Beauty School in Lexington and will be using only organic products in the salon.

Taco Bell in Danville



The official groundbreaking was in early April 2019 at the former Appalachian Tire site located on Smoot Avenue. In addition to the new Taco Bell creating jobs for the Danville area, it will also bring in traffic from U.S. 119 that will help local businesses. Little General, which owns a string of over 100 convenience stores across West Virginia will own and operate the restaurant as an independent franchisee with an expected grand opening date by the end of 2019.

Little Coal River Camping & Kayaking



Little Coal River Camping & Kayaking in Julian held their ribbon cutting ceremony on April 22, 2019. Owner Dain Bender hopes the new business will help feed the blossoming tourism interests in Boone County. The new business has tent camping, full camper hookups, concessions, kayak rentals, shuttle bus rides for kayak rentals along with bathroom and shower facilities. Little Coal River Camping & Kayaking is located north of Danville on Route 119.

Danville-Madison Pedestrian Bridge



Construction on the Danville-Madison Pedestrian Bridge began in December of 2018. The new pedestrian bridge will connect Riverside Drive and the Madison City Park with Park Avenue in Danville and become part of the popular Madison-Danville Wellness Trail. Individuals in Danville and Madison will be able to walk from one part of town to the other

without worrying about traffic or trains. The bridge will be ADA compliant and provide a safe and direct route for pedestrians between business districts, schools and restaurants. The pedestrian bridge will increase the walkability score in the Madison/Danville area and will support efforts to promote personal fitness and provide an alternative to automobile travel.

Overview for Boone County, WV

Part of: Charleston WV, Metropolitan Area



Boone County is one of about 3,142 counties and county equivalents in the United States. It has 501.5 sq. miles in land area and a population density of 49.1 per square mile. On the most recent census form, 98.3% of the population reported white alone, with 0.7% reporting African American. The population of this county is 0.7% Hispanic (of any race). The average household size is 2.50 persons.

In 2017 retail trade was the largest of 20 major sectors. It had an average wage per job of \$25,739. The per capita income grew by 20.4% from 2007 to 2017.

People & Income Overview (By Place of Residence)	Value	Rank in U.S.	Industry Overview, 2017 (By Place of Work)	Value	Rank in U.S.
Population (2017)	22,349	1700	Covered Employment	4,856	1,991
Growth (%) since 2010 Census	-9.3 %	3,042	Avg Wage per Job	\$43,228	772
Households (2017)	9,298	1,624	Manufacturing - % All Jobs	1.2 %	2,688
Labor Force (persons) (2017)	7,692	1,968	Avg Wage per Job	\$30,549	2,622
Unemployment Rate (2016)	6.3	356	Transportation/Warehousing - % All Jobs	3.4%	1,009
Per Capita Personal Income (2017)	\$31,368	2,823	Avg Wage per Job	\$40,922	2,178
Median Household Income (2017)	\$38,584	2,696	Health Care, Social Assist. - % All Jobs	5.7 %	1,854
Poverty Rate (2017)	21.4	549	Avg Wage per Job	\$47,679	533
High School Diploma or More - % of Adults 25+ (2017)	79.1 %	2,680	Finance and Insurance - % All Jobs	2.3 %	1,376
Bachelor's Degree or More - % of Adults 25+ (2017)	7.9 %	2,680	Avg Wage per Job	\$36,781	2,488

Demographics for Boone County, WV

Population over Time	Number	Rank in U.S.	Percent of West Virginia	West Virginia
2017	22,349	1,700	1.2 %	1,815,857
2010	24,629	1,614	1.3 %	1,852,994
2000	25,480	1,566	1.4 %	1,806,694
1990	25,795	1,453	1.4 %	1,792,481
1980	30,447	1,224	1.6 %	1,950,183
2000 to 2010 % Change	-3.3 %	2,432		2.6 %
1990 to 2010 % Change	-4.5 %	2,542		3.4 %
1980 to 2010 % Change	-19.1 %	2,742		-5.0 %

Source: U.S. Census Bureau

Components of Population Change (1-year change ending in 2017)	Number	Rank in U.S.	Percent of U.S.	West Virginia .
Net Domestic Migration	-366	2,742	3.6 %	-10,107
Net International Migration	-4	2,990	-1.2 %	332
Natural Increase (births minus deaths)	-78	2,841	1.9 %	-4,082
Births	220	1,837	1.2 %	18,547
Deaths	298	1,488	1.3 %	22,629

Source: U.S. Census Bureau

Population Estimates by Age in 2017	Number	Rank in U.S.	Pct Dist.	Pct Dist. in U.S.
Preschool (0 to 4)	1,247	1,736	5.4%	6.2 %
School Age (5 to 17)	3,876	1,681	16.7 %	16.7 %
College Age (18 to 24)	1,671	1,818	7.2 %	9.7%
Young Adult (25 to 44)	5,595	1,635	24.1 %	26.4 %
Older Adult (45 to 64)	6,765	1,681	17.6 %	14.9 %
Older (65 plus)	4,082	1,686	16.9 %	17.8 %
Median Age	42.5	1,178		Median Age = 37.8

Sources: U.S. Census Bureau; Median age calculated by the IBRC.

Population Estimates by Race and Hispanic Origin in 2017	Number	Rank in U.S.	Pct Dist.	Pct Dist. in U.S.
American Ind. or Alaskan Native Alone	9	2,741	0.0 %	0.8 %
Asian Alone	40	2,236	0.2 %	5.4 %
Black Alone	184	2,125	0.8 %	12.7 %
Native Hawaiian and Other Pac. Isl. Alone	0	1,730	0.0 %	0.2 %
White Alone	22,822	1,525	98.2 %	73.0 %
Two or More Race Groups	137	2,478	0.6 %	3.1 %

Hispanic or Latino (can be of any race)

Non-Hispanic or Latino	23,103	1,599	99.4 %	82.4 %
Hispanic or Latino	133	2,768	0.6 %	17.6 %

Sources: U.S. Census Bureau

Hispanic or Latino Population in 2017 (can be of any race)	Number	Rank in U.S.	Pct Dist.	Pct Dist. in U.S.
Hispanic	133	2,768	100%	100%
Mexican	95	2,712	71.4 %	63.2 %
Cuban	10	1,594	7.5 %	3.8 %
Puerto Rican	2	2,515	1.5 %	9.6 %
Other	26	2,555	19.5 %	23.4 %
White, Not Hispanic (reporting white alone)	22,733	1,464	N/A	N/A

Source: U.S. Census Bureau, American Community Survey, 5-Year Estimates

Education for Boone County, WV

Educational Attainment in 2017	Number	% of Population 25+	Rank in U.S.	U.S. % of Population 25+
Total Population 25 and Older	16,442	100%	N/A	100%
Less than 9th Grade	1066	6.5 %	780	5.4 %
9th to 12th, No Diploma	2,365	14.4 %	202	7.2 %
High School Graduate (includes equiv.)	8,238	50.1 %	20	27.3 %
Some College, No Degree	2,511	15.3 %	3,027	20.8 %
Associate Degree	968	5.9 %	2,701	8.3 %
Bachelor's Degree	739	4.5 %	3,126	19.1%
Graduate, Professional or Doctorate Degree	555	3.4 %	2,921	11.8 %

Source: U.S. Census Bureau, American Community Survey, 5-Year Estimates

Income & Poverty for Boone County, WV

Median Income	Number	Rank in U.S.	Percent of U.S.
Median Household Income in 2017	\$38,584	2,823	60.7 %
Median Household Income in 2000	\$27,475	2,785	65.4 %
Percent Change 2000 to 2017	40.4 %	1,456	

Source: U.S. Census Bureau

Per Capita Personal Income (PCPI)	Number	Rank in U.S.	Percent of U.S.
2017	\$31,368	2,736	84.7 %
2007	\$26,055	2,449	65.4 %
1997	\$16,752	2,648	64.6 %
1987	\$12,429	1,707	76.4 %
10-Year % Change	20.4 %	12	
20-Year % Change	87.2 %	1,388	
30-Year % Change	152.4 %	2,163	

Source: U.S. Bureau of Economic Analysis

Personal Income in 2017 (\$000)	Number	5-Year % Change (adj*)	Rank in U.S.
Total Earnings by Place of Work	\$328,654	-46.3 %	3,082
Minus: Contributions for Government Social Insurance	\$47,261	-28.9 %	3,112
Personal Contributions for Government Social Insurance	\$27,517	-14.1 %	3,104
Employer Contributions for Government Social Insurance	\$19,745	-42.6 %	3,113
Plus: Adjustment for Residence	\$63,381	-177.4 %	3,035
Equals: Net Earnings by Place of Residence	\$344,744	-25.6 %	2,988
Plus: Dividends, Rent, Interest	\$77,331	6.2 %	2,795
Plus: Transfer Payments	\$278,943	12.9 %	2,664
Equals: Personal Income by Place of Residence	\$701,048	-10.5 %	2,990

Source: U.S. Bureau of Economic Analysis

Poverty Estimates	Number	Rank in U.S.	Percent Change	Rank in U.S.
Poverty Rate in 2017	21.4	459	--	--
In 2000	18.4	527	16.3 %	1,619
Poverty Rate for Children under 18 in 2017	29.7	534	--	--
In 2000	25.6	572	16.0 %	1,643

Source: U.S. Census Bureau

Jobs & Earnings for Boone County, WV

BEA Major Sectors (NAICS) in 2016 (by place of work)	Earnings (\$000)	Avg Earnings Per Job	Rank in U.S.	Jobs	Pct Dist. in County	Pct Dist. in U.S.
Earnings by place of work - 35	\$328,654	\$53,128	501	6,186	100.0%	100.0%
Wage and salary disbursements - 50	\$236,802	\$44,146	765	5,364	86.7%	77.4%
Proprietors' income - 70	\$29,844	\$36,306	389	822	13.3%	22.6%
Farm proprietors' income - 71	\$65	\$3,823	1,560	17	0.3%	0.9%
Nonfarm proprietors' income - 72	\$29,779	\$36,992	276	805	13.0%	21.7%
Farm earnings - 81	\$65	\$3,823	1,996	17	0.3%	1.3%
Nonfarm earnings - 82	\$328,589	\$53,264	499	6,169	99.7%	98.7%
Private earnings - 90	\$250,646	\$54,583	316	4,592	74.2%	86.2%
Forestry, fishing, related activities, and other - 100	\$0	N/A	1	0	0.0%	0.5%
Mining - 200	\$0	N/A	1	0	0.0%	0.8%
Utilities - 300	\$3,942	\$98,550	659	40	0.6%	0.3%
Construction - 400	\$4,176	\$39,028	2,271	107	1.7%	5.4%
Manufacturing - 500	\$3,201	\$35,175	2,471	91	1.5%	6.8%
Retail Trade - 700	\$20,126	\$26,727	1,622	753	12.2%	9.8%
Transportation and warehousing - 800	\$32,317	\$120,137	42	269	4.3%	3.9%
Information - 900	\$0	N/A	1	0	0.0%	1.7%

Source: U.S. Bureau of Economic Analysis (BEA)

Jobs & Wages for Boone County, WV

Annual Covered Employment and Wages Over Time (NAICS)	Establishments	Jobs	Average Wage Per Job	Rank in U.S.	Pct of U.S. Avg Wage
2017	408	4,856	\$43,228	772	78.0%
2016	421	4,957	\$41,032	889	98.5%
2015	437	5,942	\$45,898	449	110.0%
2014	444	6,708	\$48,784	292	118.4%
2013	444	7,293	\$50,672	174	126.0%
2012	430	7,945	\$54,381	104	136.9%
2011	427	8,640	\$58,455	57	149.5%
2010	435	8,616	\$52,650	87	139.7%
2009	439	8,605	\$51,895	74	140.6%
2008	439	8,743	\$49,786	102	138.3%
2007	447	8,342	\$46,310	135	135.8%
10-Year Change	-39	-3,486	(\$3,082)		
10-Year Percent Change	-8.7%	-41.8%	-6.7%		

Source: U.S. Bureau of Labor Statistics (BLS)

D = Non-Discloseable Data; N/A = Not Available; Note: Average wage may not match published numbers due to rounding.

Annual Industry Distribution of Jobs and Avg. Wage in 2017 (NAICS)	Establishments	Jobs	Pct. Dist.	Annual Average Wage Per Job	Rank in U.S.
Total	408	4,856	100.0%	\$43,228	772
Agriculture, Forestry, Fishing and Hunting	2	0	0.0%	\$0	1,715
Mining	16	0	0.0%	\$0	1,168
Utilities	7	31	0.6%	\$84,833	655
Construction	12	48	1.0%	\$43,219	1,639
Manufacturing	4	56	1.2%	\$30,549	2,622
Wholesale Trade	10	45	0.9%	\$43,386	1,801
Retail Trade	65	621	12.8%	\$25,739	1,364
Transportation & Warehousing	41	166	3.4%	\$40,922	2,178
Information	7	0	0.0%	N/A	1
Finance and Insurance	18	114	2.3%	\$36,781	2,488
Real Estate and Rental and Leasing	8	0	0.0%	\$0	2,572
Professional, Scientific, and Technical Services	28	190	3.9%	\$82,920	197
Management of Companies and Enterprises	7	55	1.1%	\$121,921	159
Admin. & Support & Waste Mgt. & Rem. Services	19	118	2.4%	\$23,277	1,985
Educational Services	20	551	11.3%	\$38,096	781
Health Care and Social Services	45	277	5.7%	\$47,679	533
Arts, Entertainment, and Recreation	5	16	0.3%	\$19,128	1,008
Accommodation and Food Services	21	268	5.5%	\$14,364	1,386
Other Services (Except Public Administration)	52	207	4.3%	\$23,371	2,201
Public Administration	23	403	8.3%	\$33,914	2,244

Source: U.S. Bureau of Labor Statistics (BLS)

D = Not shown to avoid disclosure of confidential information.

N/A = This item is not available.

Note: Average wage may not match published numbers due to rounding.

Labor Force for Boone County, WV

Labor Force Annual Averages in 2017	Number	Rank in U.S.	% of U.S.	U.S.
Total Labor Force	7,692	1,968	1.0 %	778,821
5-Year % Change	-13.8 %	3,026	--	0.0 %
10-Year % Change	-18.6 %	2,856	--	-4.0 %
Employed	7,209	1,976	1.0 %	738,309
5-Year % Change	-9.8 %	2,975	--	-1.2 %
10-Year % Change	-20.0 %	2,907	--	-4.6 %
Unemployed	483	1,666	12 %	40,512
5-Year % Change	-47.9 %	2,173	--	-33.1 %
10-Year % Change	8.3 %	810	--	9.0 %
Unemployment Rate	6.3	356	121.2 %	5.2
5-Year % Change	-39.4 %	1,402	--	-30.7 %
10-Year % Change	34.0 %	239	--	13.0 %

Source: U.S. Bureau of Labor Statistics

Living Arrangements for Boone County, WV

Households in 2017	Number	Rank in U.S.	Pct. Dist.	Pct. Dist. in U.S.
Total Households	9,298	1,624	100%	100%
Family Households	6,530	1,583	70.2%	65.9%
Married with Children	1,631	1,614	17.5%	19.1%
Married without Children	3,143	1,617	33.8%	29.2%
Single Parents	701	1,736	7.5%	9.1%
Other	1,055	1,243	11.3%	8.4%
Non-Family Households	2,768	1,711	29.8%	34%
Living Alone	2,324	1,735	25.0%	27.7%
Average Household Size	2.40	1,508		

Source: U.S. Census Bureau

Housing Units in 2017	Number	Rank in U.S.	Pct. Dist.	Pct. Dist. in U.S.
Total Housing Units (ACS estimate)	11,155	1,669	100%	100%
Occupied	9,298	1,624	83.4%	87.8%
Owner Occupied	7,148	1,569	64.1%	56.0%
Renter Occupied	2,150	1,754	19.3%	31.8%
Vacant	1,857	1,677	16.6%	12.2%
For Seasonal or Recreational Use	146	2,439	1.3%	4.0%

Source: U.S. Census Bureau

Residential Building Permits in 2017	Units	Pct Dist.	Pct Dist. in U.S.	Cost (\$000)
Total Permits Filed	10	100%	100%	\$1,573
Single Family	10	100.0 %	64.0%	\$1,573
Two Family	0	0.0 %	1.5%	\$0
Three and Four Family	0	0.0 %	1.4%	\$0
Five Families and More	0	0.0 %	33.1%	\$0

Source: U.S. Census Bureau



StatsAmerica is a service of the [Indiana Business Research Center](#) at Indiana University's Kelley School of Business. This initiative is funded in part by the U.S. Commerce Department's [Economic Development Administration](#).

Top Ten Employers in Boone County

1. Boone County Board of Education
2. Blackhawk Mining, LLC, Inc.
3. Alpha Natural Resources Co.
4. Boone Memorial Hospital, Inc.
5. Panhandle Support Services, Inc.
6. Boone County Commission
7. Hillcrest Health Care Center, LLC
8. Black Oak Mining, LLC
9. Loved Ones In-Home Care, LLC
10. Kroger

Source: Workforce WV, March 2019

CLAY COUNTY



Buffalo Creek



Historic Clay County Courthouse

Clay County was formed in 1858 from parts of Braxton, Kanawha and Nicholas counties. Named in honor of Henry Clay, a Kentucky statesman, Clay County is located in central West Virginia. The county area is 346.61 square miles and the 2000 census shows a population of 10,330. The mean annual temperature is 55 degrees and the mean annual snowfall ranges from 25-40 inches. The variation is due to mountainous terrain. Two-thirds of the county lies at elevations of 1,000 feet or more above sea level. The county seat is the Town of Clay, located 42 miles from Charleston, West Virginia, the state capital.

Distance to Major Cities from Clay

Atlanta.....	511 miles
Chicago.....	589 miles
Cincinnati.....	301 miles
Cleveland.....	294 miles
Columbus.....	205 miles
Lexington, KY.....	222 miles
New York.....	509 miles
Pittsburgh.....	204 miles
Washington, DC.....	336 miles

Economy

Clay County is the poorest county in the region with a median household income in 2017 of \$34,321. It is designated by the Appalachian Regional Commission as “distressed”. Economic challenges include its relative inaccessibility and lack of developable land. Over half of workers living in Clay County commute outside the county to work. In 2017, health care and social assistance was the largest employment sector, with the largest single employer being the Clay County Board of Education.

Clay County is included in a federally designated Enterprise Community, named the Central Appalachia Empowerment Zone of West Virginia (CAEZ), and as such, is entitled to increased state and federal grant assistance. In the application for funding as a Rural Empowerment Zone, the following five areas of need are highlighted: 1) Economic Development; 2) Education; 3) Housing; 4) Health and 5) Emergency Services.

As a result of CAEZ, improvements in the education system have occurred: pre-school programs are in place at elementary schools and a program in Clay County High School teaches students to build houses.

TRANSPORTATION

Highways

Clay County is served by I-79, which provides service from Charleston, WV to Erie, PA and State Routes 36, 16 and 4.

Public Transportation

Specialized Transportation, primarily for the elderly, is provided by the Clay County Development Corporation.

Rail Service

Clay County currently has no operating rail lines.

Bus Service

No public bus service is available.

Air Service

Service to Clay County is provided by Yeager Airport, located 10 minutes from downtown Charleston and about an hour from Clay.

UTILITIES

Water

Water is provided by The Town of Clay, Clay County Public Service District, Clay-Roane Public Service District, and Queen Shoals Public Service District.

Electric

Elk Power, American Electric Power (AEP) and Allegheny Power provide electrical power to the area.

Gas and Other

Mountaineer Gas is the major provider.

The following "Quality of Life" facts exist in Clay County:

- Low Crime Rate
- Two County-wide Ambulance Services
- Fully Equipped Volunteer Fire Department
- One National Blue-Ribbon School
- Public Library
- Valley Fork Learning Center
- Primary Health Care Center

- Nursing and Rehabilitation Center
- Clay County Wellness Center
- Annually held Events Include the Golden Delicious Apple Festival, the July 4th Celebration, and Agricultural Fair
- County and Municipal Park and Pool
- 28-acre Park Near Maysel
- Fishing, Swimming and Canoeing is Available on the Elk River
- J. G. Bradley Campground
- Buffalo and Gauley Creek Scenic Railroad
- Within 1 hour of State Capitol

Rail Trail Planned Along Elk River and Buffalo Creek



Governor Jim Justice announced on May 8, 2019 that the state plans to build a major rail trail along the Elk River and Buffalo Creek. The state plans to utilize 72 miles of existing rail lines in Clay and Kanawha counties and either repurpose the tracts for recreational purposes or convert them into trails for walking, hiking, biking and other activities. The planned trail network has the potential to become the second longest rail trail east of the Mississippi and is hoped to attract tourists from all over the country and help boost the local economy. The 72-mile system would be divided into two sections. The Elk River Trail will extent across 54 miles and run next to the Elk River starting in Clendenin and ending south of Duck on the border for Braxton County. The Elk River Trail will be perfect for hiking and biking and will also provide access to boating, fishing and kayaking opportunities on the Elk River. The Buffalo Creek Trail will branch from the Elk River Trail and run 18 miles along Buffalo Creek, starting near the Town of Clay and ending at Widen. The Buffalo Creek section will offer a walking and biking trail. The state hopes to have portions of the new rail trail open and running by the summer of 2020.

Buffalo Creek Rail Rides Pedal-Train Excursion



A new pedal-train excursion that runs along the Buffalo Creek and into the mountains is attracting tourists to Clay County. The journey takes approximately 2.5 hours and can be made by four-seat pedal carts or towed by a small motorized speeder. The Buffalo Creek Rail Rides have hosted visitors from 27 different states and several different countries as they ride along the

scenic landscape and historic sites. Five stops are scheduled on the route and highlights include the remnants of a train wreck, 70-foot Devil's Sawmill Falls and the pre-railroad Adair Cemetery dating from the 1800's. Rail fans are also interested in the cut-stone bridges and Pittsburgh-sourced ironwork. Excursions are conducted at 9:00 a.m., 1:00 p.m. and 5:00 p.m. Thursday through Monday.

Community Development Block Grant for Broadband Development



Clay, Calhoun and Roane counties received a \$125,000 Community Development Block Grant to develop a broadband feasibility and business plan for their counties. This planning project promotes a regional approach to provide a roadmap for broadband throughout the three counties. The CCR

Regional Broadband Development Committee was formed and is working tirelessly to bring high speed internet services to the region.

Clay Recycling Now Open



Clay Recycling, which is owned and operated by WT Bevins opened this past summer at 276 Precious Maysel

Road in Maysel. Clay Recycling is the only recycling location in Clay County. Some of the items that they accept for recycling are stainless, radiators, brass, batteries, aluminum, copper, miscellaneous items such as die cast, magnesium and electronic motors. Clay Recycling also provides a roll-off container for the public to drop off any unwanted ferrous metals and appliances.

Clay County Receives School Violence Prevention Program Grant



The Clay County Commission, in partnership with Clay County Schools received a School Violence Prevention Program (SVPP) grant award in the amount of \$207,933. This grant award will make numerous security measures possible for Clay County Schools. The grant will provide funds for training local law enforcement officers in the prevention of, and response to school violence. In addition, once law enforcement officers receive training, they will then provide training to teachers and

students in the prevention of school violence. Security measures throughout the county's six schools will also be increased by items such as handheld metal detectors, new surveillance cameras, updated keyless entry systems, and classroom call systems funded through the grant.

Overview for Clay County, WV

Part of: Charleston WV, Metropolitan Area



Clay County is one of about 3,142 counties and county equivalents in the United States. It has 341.9 sq. miles in land area and a population density of 27.5 per square mile. On the most recent census form, 98.3% of the population reported white alone, with 0.2% reporting African American. The population of this county is 0.8% Hispanic (of any race). The average household size is 2.62 persons.

In 2017 health care and social assistance was the largest of 20 major sectors. It had an average wage per job of \$22,322. The per capita income grew by 31.5% from 2007 to 2017.

People & Income Overview (By Place of Residence)	Value	Rank in U.S.	Industry Overview, 2017 (By Place of Work)	Value	Rank in U.S.
Population (2017)	8,764	2,507	Covered Employment	1,375	2,826
Growth (%) since 2010 Census	-6.6 %	2,881	Avg Wage per Job	\$30,879	2,909
Households (2017)	3,365	2,534	Manufacturing - % All Jobs in County	0.0 %	2,773
Labor Force (persons) (2017)	3,175	2,657	Avg Wage per Job	\$0	2,774
Unemployment Rate (2017)	8.6	72	Transportation & Warehousing - % All Jobs in County	0.9%	2,318
Per Capita Personal Income (2017)	\$28,588	3,011	Avg Wage per Job	\$32,439	2,984
Median Household Income (2017)	\$34,321	2,963	Health Care, Social Assist. - % All Jobs in County	23.8%	69
Poverty Rate (2017)	27.3	153	Avg Wage per Job	\$22,322	2,121
High School Diploma or More - % of Adults 25+ (2017)	74.5%	2,982	Finance and Insurance - % All Jobs in County	N/A	2,682
Bachelor's Degree or More - % of Adults 25+ (2017)	9.0%	2,982	Avg Wage per Job	N/A	2,682

Demographics for Clay County, WV

Population over Time	Number	Rank in U.S.	Percent of West Virginia	U.S.
2017	8,764	2,507	0.5 %	1,815,857
2010	9,386	2,471	0.5 %	1,852,994
2000	10,303	2,439	0.6 %	1,806,694
1990	9,952	2,416	0.6 %	1,792,481
1980	11,265	2,279	0.6 %	1,950,183
2000 to 2010 % Change	-8.9 %	2,871		2.6 %
1990 to 2010 % Change	-5.7 %	2,611		3.4 %
1980 to 2010 % Change	-16.7 %	2,690		-5.0 %

Source: U.S. Census Bureau

Components of Population Change (1-year change ending in 2017)	Number	Rank in U.S.	Percent of U.S.	U.S.
Net Domestic Migration	-80	2,090	0.8 %	-10,507
Net International Migration	0	2,447	0.0 %	867
Natural Increase (births minus deaths)	2	1,838	-0.1 %	-3,129
Births	113	2,414	0.6 %	19,098
Deaths	111	2,400	0.5 %	22,227

Source: U.S. Census Bureau Population Estimates by Age in 2017	Number	Rank in U.S.	Pct Dist.	Pct Dist. in U.S.
Preschool (0 to 4)	510	2,496	5.7 %	6.2%
School Age (5 to 17)	1,520	2,486	17.1 %	16.7%
College Age (18 to 24)	635	2,561	7.1%	9.7%
Young Adult (25 to 44)	1,946	2,529	21.9%	26.4%
Older Adult (45 to 64)	2,613	2,469	29.4%	26.15
Older (65 plus)	1,677	2,519	18.8%	14.9%
Median Age	43.4	909		Median Age = 37.8

Sources: U.S. Census Bureau; Median age calculated by the IBRC.

Population Estimates by Race and Hispanic Origin in 2017	Number	Rank in U.S.	Pct Dist.	Pct Dist. in U.S.
American Ind. or Alaskan Native Alone	43	2,182	0.5 %	0.8%
Asian Alone	0	2,889	0.0 %	5.4%
Black Alone	2	3,015	0.0 %	12.7
Native Hawaiian and Other Pac. Isl. Alone	12	1,258	0.1%	0.2%
White Alone	8,718	2,383	97.9%	73.0%
Two or More Race Groups	117	2,552	1.3%	3.1%
Hispanic or Latino (can be of any race)				
Non-Hispanic or Latino	8,877	2,446	99.7%	82.4%
Hispanic or Latino	24	3,071	0.3%	17.6%

Sources: U.S. Census Bureau

Hispanic or Latino Population in 2017 (can be of any race)	Number	Rank in U.S.	Pct Dist.	Pct Dist. in U.S.
Hispanic	24	3,071	100%	100%
Mexican	0	3,109	0.0 %	63.2%
Cuban	0	1,950	0.0 %	3.8%
Puerto Rican	12	2,213	50.0%	9.6%
Other	12	2,781	50.0%	23.4%
White, Not Hispanic (reporting white alone)	8,694	2,305	N/A	N/A

Source: U.S. Census Bureau, American Community Survey, 5-Year Estimates

Education for Clay County, WV

Educational Attainment in 2017	Number	Percent of Population 25+	Rank in U.S.	U.S. % of Population 25+
Total Population 25 and Older	6,236	100%	N/A	100%
Less than 9th Grade	854	13.7%	107	5.4%
9th to 12th, No Diploma	736	11.8%	609	7.2%
High School Graduate (includes equiv.)	3,241	52.0%	7	27.3%
Some College, No Degree	594	9.5%	3,139	20.8%
Associate Degree	251	4.0%	3,063	8.3%
Bachelor's Degree	316	5.1%	3,102	19.1%
Graduate, Professional or Doctorate Degree	244	3.9%	2,755	11.8%

Source: U.S. Census Bureau, American Community Survey, 5-Year Estimates

Income & Poverty for Clay County, WV

Median Income	Number	Rank in U.S.	Percent of U.S.
Median Household Income in 2017	\$34,321	2,963	56.9%
Median Household Income in 2000	\$23,605	3,049	56.2%
Percent Change 2000 to 2017	45.4%	919	

Source: U.S. Census Bureau

Per Capita Personal Income (PCPI)	Number	Rank in U.S.	Percent of U.S.
2017	\$28,588	3,011	55.4%
2007	\$21,738	2,989	54.6%
1997	\$12,736	3,076	49.1%
1987	\$7,374	3,086	45.3%
10-Year % Change	31.5%	12	
20-Year % Change	124.5%	49	
30-Year % Change	287.7%	202	

Source: U.S. Bureau of Economic Analysis

Personal Income in 2017 (\$000)	Number	5-Year % Change (adj*)	Rank in U.S.
Total Earnings by Place of Work	\$71,721	-33.3%	3,046
Minus: Contributions for Government Social Insurance	\$11,674	-9.5%	3,083
Personal Contributions for Government Social Insurance	\$7,607	6.2%	3,071
Employer Contributions for Government Social Insurance	\$4,067	-29.1%	3,101
Plus: Adjustment for Residence	\$65,328	32.2%	751
Equals: Net Earnings by Place of Residence	\$125,375	-13.0%	2,828
Plus: Dividends, Rent, Interest	\$28,313	-1.3%	2,993
Plus: Transfer Payments	\$96,855	12.1%	2,746
Equals: Personal Income by Place of Residence	\$250,543	-3.3%	2,860

Source: U.S. Bureau of Economic Analysis

Poverty Estimates	Number	Rank in U.S.	Percent Change	Rank in U.S.
Poverty Rate in 2017	27.3	153	--	--
In 2000	24.2	138	12.8% %	1,850
Poverty Rate for Children under 18 in 2017	37.4	181	--	--
In 2000	34.0	114	10.0 %	2,018

Source: U.S. Census Bureau

Jobs & Earnings (BEA) for Clay County, WV

BEA Major Sectors (NAICS) in 2017 (by place of work)	Earnings (\$000)	Avg Earnings Per Job	Rank in U.S.	Jobs	Pct Dist. in County	Pct Dist. in U.S.
Earnings by place of work - 35	\$71,721	\$33,894	2,656	2,116	100.0%	100.0%
Wage and salary disbursements - 50	\$47,360	\$31,468	2,924	1,505	71.1%	77.4%
Proprietors' income - 70	\$10,336	\$16,916	2,086	611	28.9%	22.6%
Farm proprietors' income - 71	(\$62)	(\$613)	1,851	101	4.8%	0.9%
Nonfarm proprietors' income - 72	\$10,398	\$20,388	1,762	510	24.1%	21.7%
Farm earnings - 81	(\$55)	(\$539)	2,300	102	4.8%	1.3%
Nonfarm earnings - 82	\$71,776	\$35,638	2,702	2,014	95.2%	98.7%
Private earnings - 90	\$48,055	\$32,295	2,636	1,488	70.3%	86.2%
Forestry, fishing, related activities, and other - 100	\$1,226	\$51,083	134	24	1.1%	0.5%
Mining - 200	\$0	N/A	1	0	0.0%	0.8%
Utilities - 300	\$0	\$0	1,389	8	0.4%	0.3%
Construction - 400	\$4,455	\$27,331	2,684	163	7.7%	5.4%
Manufacturing - 500	\$0	N/A	1	0	0.0%	6.8%
Retail Trade - 700	\$4,180	\$21,326	2,613	196	9.3%	9.8%
Transportation and warehousing - 800	\$0	N/A	1	0	0.0%	3.9%
Information - 900	\$0	N/A	1	0	0.0%	1.7%

Source: U.S. Bureau of Economic Analysis (BEA)

D = Not shown to avoid disclosure of confidential information, but the estimates for this item are included in the totals.

L = Less than 10 jobs, but the estimates for this item are included in the totals.

N/A = Not available or not applicable.

* = "Other" consists of the number of jobs held by U.S. residents employed by international organizations and foreign embassies and consulates in the United States.

Jobs & Wages (BLS) for Clay County, WV

Annual Covered Employment and Wages Over Time (NAICS)	Establishments	Jobs	Average Wage Per Job	Rank in U.S.	Pct of U.S. Avg Wage
2017	137	1,375	\$30,879	2,909	55.7%
2016	142	1,390	\$31,327	2,748	75.2%
2015	140	1,385	\$31,376	2,678	75.2%
2014	147	1,409	\$31,272	2,552	75.9%
2013	159	1,516	\$31,141	2,378	77.5%
2012	158	1,771	\$37,661	967	94.8%
2011	158	1,860	\$42,064	446	107.6%
2010	161	1,863	\$37,936	670	100.7%
2009	161	2,029	\$38,956	498	105.6%
2008	157	2,100	\$35,931	759	99.8%
2007	156	2,088	\$39,787	352	116.7%
10-Year Change	-19	-713	(\$912)		
10-Year Percent Change	-12.2 %	-34.1%	-22.4%		

Source: U.S. Bureau of Labor Statistics (BLS)

D = Non-Discloseable Data; **N/A** = Not Available; Note: Average wage may not match published numbers due to rounding.

Annual Industry Distribution of Jobs and Avg. Wage in 2017 (NAICS)	Establishments	Jobs	Pct. Dist.	Annual Average Wage Per Job	Rank in U.S.
Total	137	1,375	100.0%	\$30,879	2,909
Agriculture, Forestry, Fishing and Hunting	4	7	0.5%	\$31,151	1,196
Mining	3	0	0.0%	\$0	1,168
Utilities	3	0	0.0%	\$0	1,587
Construction	18	89	6.5%	\$30,222	2,707
Manufacturing	3	0	0.0%	\$0	2,774
Wholesale Trade	3	0	0.0%	\$0	2,372
Retail Trade	16	136	9.9%	\$23,557	2,174
Transportation & Warehousing	15	12	0.9%	\$32,439	2,984
Information	2	0	0.0%	\$0	2,411
Finance and Insurance	2	0	0.0%	\$0	2,682
Admin. & Support & Waste Mgt. & Rem. Services	4	4	0.3%	\$12,717	2,277
Educational Services	7	0	0.0%	\$0	1,937
Health Care and Social Services	22	327	23.8%	\$22,322	2,121
Accommodation and Food Services	6	44	3.2%	\$13,544	1,685
Other Services (Except Public Administration)	19	60	4.4%	\$29,047	1,200
Public Administration	11	97	7.1%	\$24,534	2,928

Source: U.S. Bureau of Labor Statistics (BLS)

Labor Force for Clay County, WV

Labor Force Annual Averages in 2017	Number	Rank in U.S.	% of U.S.	U.S.
Total Labor Force	3,157	2,657	0.4 %	778,821
5-Year % Change	-10.1 %	2,870	--	0.0 %
10-Year % Change	-9.3 %	2,265	--	-4.0 %
Employed	2,903	2,677	0.4 %	738,309
5-Year % Change	-6.5 %	2,834	--	-1.2 %
10-Year % Change	-10.8 %	2,321	--	-4.6 %
Unemployed	272	2,225	0.7 %	40,512
5-Year % Change	-36.0 %	1,019	--	-33.1 %
10-Year % Change	11.0 %	708	--	9.0 %
Unemployment Rate	8.6	72	165.4 %	5.2
5-Year % Change	-28.3 %	648	--	-30.7 %
10-Year % Change	22.9 %	444	--	13.0 %

Source: U.S. Bureau of Labor Statistics

Living Arrangements for Clay County, WV

Households in 2017	Number	Rank in U.S.	Pct. Dist.	Pct. Dist. in U.S.
Total Households	3,365	2,534	100%	100%
Family Households	2,289	2,520	68.0%	65.9%
Married with Children	543	2,545	16.1%	19.1%
Married without Children	1,248	2,482	37.1%	29.2%
Single Parents	173	2,740	5.1%	9.1%
Other	325	2,265	9.7%	8.4%
Non-Family Households	1,076	2,564	32.0%	34.1%
Living Alone	787	2,677	23.4%	27.7%
Average Household Size	2.60	580		

Source: U.S. Census Bureau

Housing Units in 2017	Number	Rank in U.S.	Pct. Dist.	Pct. Dist. in U.S.
Total Housing Units (ACS estimate)	4,630	2,501	100%	100%
Occupied	3,365	2,534	72.7%	87.8%
Owner Occupied	2,739	2,456	59.2%	56.0%
Renter Occupied	626	2,704	13.5%	31.8%
Vacant	1,265	2,087	27.3%	12.2
For Seasonal or Recreational Use	604	1,307	13.0%	4.0%

Source: U.S. Census Bureau

Residential Building Permits in 2017	Units	Pct Dist.	Pct Dist. in U.S.	Cost (\$000)
Total Permits Filed	0	100%	100%	\$0
Single Family	0	N/A	64.0%	\$0
Two Family	0	N/A	1.5%	\$0
Three and Four Family	0	N/A	1.4%	\$0
Five Families and More	0	N/A	33.1%	\$0

Source: U.S. Census Bureau



StatsAmerica is a service of the [Indiana Business Research Center](#) at Indiana University's Kelley School of Business. This initiative is funded in part by the U.S. Commerce Department's [Economic Development Administration](#).

Top 10 Employers in Clay County

1. Clay County Board of Education
2. Clay County Development Corporation
3. Clay Health Care Center, LLC
4. Community Care of West Virginia, Inc.
5. Goulds Electric Motor Repair, Inc.
6. Clay County Commission
7. Advantage Home Care, LLC
8. Gino's/Tudors Biscuit World
9. Pierson Lumber Company
10. West Virginia Department of Highways

Source: Workforce WV, March 2019

KANAWHA COUNTY



Clay Center for the Arts and Science



Downtown Charleston

Kanawha County combines the scenic beauty of the Appalachian Mountains with the developmental potential provided by a major river system and mild climate. It is the largest county in the region with a population of 180,454 in 2018. The Kanawha River Valley provides much of the flat land used for development in the area. In addition, the Elk River and Coal River serve Kanawha County. In Charleston, the Kanawha River lies at 600 feet above sea level. Kanawha County has 913 square miles. The area’s geographical location and surrounding mountains insulate it from tornadoes and hurricanes. The mean annual precipitation is 42 inches; snowfall averages 32 inches per year.

Distance to Major Cities from Charleston

Atlanta.....	504 miles
Chicago.....	541 miles
Cincinnati.....	200 miles
Cleveland.....	252 miles
Columbus.....	167 miles
Lexington.....	178 miles
New York.....	530 miles
Pittsburgh.....	227 miles
Washington, DC.....	361 miles

Economy

Population has shrunk in the Kanawha Valley for nearly 25 years. In the 1960 census, Charleston had 86,000 in population and Kanawha County 253,000. Today, the capital city is slipping below 50,000 and the county below 190,000. The reason for the Kanawha Valley’s decreasing numbers, is due to loss of jobs. Chemical plants automated, glass plants closed, and coal mining jobs saw a steady decline. However, there are successes in the county, South Charleston’s Gestamp provides over 400 good paying jobs and the South Charleston Technology Park and Mid-Atlantic Technology Research and Innovation Center have been successful.

Major industries in Kanawha County include healthcare and social services, retail trade and public administration. There are 4,880 businesses in Kanawha County, representing more employment opportunities than any county in West Virginia.

There are fourteen (14) municipalities in Kanawha County: They are: Belle, Cedar Grove, Charleston, Chesapeake, Clendenin, Dunbar, East Bank, Glasgow, Handley, Marmet, Nitro, Pratt, St. Albans and South Charleston.

Transportation

Highways

Three major interstates serve the Kanawha Valley: I-64, I-79 and I-77.

Planned Highway Improvements:

WV 601 (Jefferson Road) Improvements in South Charleston:

- Widen to five lanes from MacCorkle Avenue to Kanawha Turnpike
- Widen to four lanes from Kanawha Turnpike to US 119 (Corridor G)
- Construct a connector road from RHL Blvd. at Trace Fork Shopping Center to Jefferson Road.
- Construct a flyover bridge over CSX mainline tracks and Kanawha Turnpike.

Funding Source: FHWA and WVDOT

Cost: \$60 million

Interstate 64 Widening + Nitro Bridge

- Widen I-64 from 4 to 6 lanes between the US 35 Interchange (Exit 40) and Crooked Creek (Exit 45).
- New bridge to increase capacity across Kanawha County/Putnam County boundary line.

Funding Source: FHWA and WVDOT

Cost: \$72 million

US 60 Improvements in Kanawha County: Widen to four lane divided facility from Admiral TJ Lopez Bridge (Chelyan Bridge) to CR 81 (Kelly's Creek Road).

Funding Source: FHWA and WVDOT

Cost: \$31.3 million

Public Transportation

The Kanawha Valley Regional Transportation Authority (KVRTA) serves Kanawha County and portions of Fayette and Putnam Counties. KVRTA operates a network of 20 fixed routes oriented around the commercial center of Charleston.

Rail Service

Rail freight service is supplied by CSX, on the southern side of the Kanawha River, and Norfolk-Southern on the northern side of Kanawha River.

Amtrak offers limited passenger service several times a week.

Air Service

Yeager Airport in Charleston offers competitive airfares to destinations throughout the world and nonstop flights to eight major cities. The airport is a short drive from downtown Charleston and only a few minutes from the intersection of three major interstates. Yeager Airport serves as a U.S. Customs Port of Entry and has 4 major airlines: American, United, Delta, and Spirit.

UTILITIES

Water

WV-American Water provides water through most of Kanawha County. There are also some municipal providers and PSD's.

Electric

American Electric Power (AEP) provides electrical power throughout Kanawha County.

Gas and Other

Natural gas is supplied by Mountaineer Gas. Coal, fuel oil and propane are readily available from local suppliers.

Infor Opens Location in Charleston



Infor, a global technology company, opened a new office on the 6th floor of Laidley Tower in Charleston. The Charleston operation runs cloud applications for local, state and federal government agencies and government contractors supporting these agencies. Infor anticipates that it will hire 100 technical employees for specialized positions and support services, the office will expand as Infor adds additional customers. Infor is also partnering with Marshall University and West Virginia State University to build a pipeline of skilled talent that is trained in software engineering, cloud operations and support services related to Infor products.

Kanawha County Public Library Renovations and Expansion



The Kanawha County Public Library is moving ahead with plans to renovate and expand the downtown library. The renovations and expansion will allow the library to provide a more efficient service while also serving as more of a community center. The new library will include

80,000 square feet of space: 60,000 square feet fully renovated and 20,000 square feet of expanded space that is made up of two new additions. The renovations also include a proposed third floor covered walkway above Quarrier Street that will take patrons from the Summers Street Parking Garage to the library, which will address the current lack of parking available at the library. The new library will also include 10,000 square feet of children's activity space, which is more than double the current space available. More public space for the community will also be available which will include reading areas, study rooms and flexible meeting space for groups as large as 200. The newly renovated library will also include a café and a craft room. The Kanawha County Public Library is seeking funding through federal tax credit programs but has secured most of its funding through private donations. The entire project is estimated to cost around \$27 million with construction expected to begin this year.

Coal River Coffee Company Opens in St. Albans



The Coal River Coffee Company located at 64 Olde Main Plaza in St. Albans held its grand opening in August 2018. They offer a full espresso bar that provides an array of beverage choices, including sugar-free options. They also offer tea from Larkin Tea Company out of West Virginia as well as Italian sodas. Food options include gluten-free and dairy-free items, with breakfast and lunch options available. The shop also displays work from local artists and hosts open mic nights for local performers.

Shawnee Park Multi-Sports Complex Opens in Dunbar



The Shawnee Park Multi-Sports Complex opened to the public in July 2018. The sports complex is a \$10.2 million project and includes six turf soccer and lacrosse fields, four baseball and softball fields, a basketball court and a new community building. The sports complex hosts local and regional youth sports tournaments which will bring in money from outside the area and will help spur local

economic development and increase tourism in the Kanawha Valley. The economic impact from the complex is estimated to be around \$40 million dollars a year for the Kanawha Valley.

Buzz Foods to Add Slaughterhouse and Livestock Processing Facility



Buzz Foods plans to expand its operations in Charleston through the Abandoned Mine Lands (AML) Pilot Program to include a new slaughterhouse and livestock

processing facility. The new facility is expected to be nearly 10,000 square-feet and cost about \$2 million. Construction will begin this summer and is expected to be completed by next winter. The new top-of-the line slaughterhouse is expected to provide between 25-30 full-time jobs. Adding slaughter and value-added processing activities to the companies already existing business will create new selling opportunities for local livestock producers as well as help the local meat industry meet consumer demand. This AML Pilot project will provide a way for the livestock to be processed locally, West Virginia produces world-class beef, pork, and lamb, but much of the value is lost when the animals are shipped away to be processed. The new facility will help create vital opportunities for local farmers and entrepreneurs while helping to diversify the local economy.

Park Place Commercial Center in South Charleston

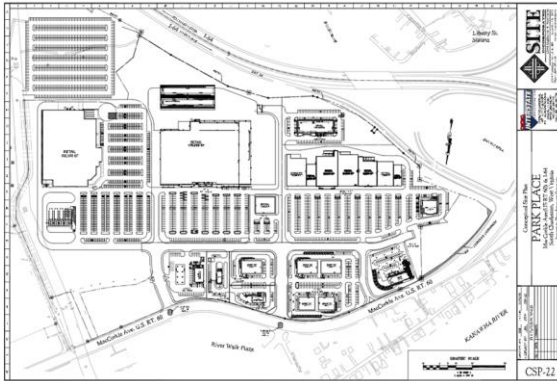

Work is moving along to develop the Park Place Commercial Center located across from Riverwalk Plaza on MacCorkle Avenue in South Charleston. Totalling over 400,000 square feet of space, Park Place will be home to large anchor stores, retail outlets, and restaurants. Park Place will be an economic boost to South Charleston and the surrounding areas. The West Virginia Legislature

and Development Office approved this location as a Tax Increment Financing (TIF) District called The South Charleston Park Place Economic Opportunity Development District. This TIF District could result in more than \$350 million in public and privately funded economic development projects including a new community center, an educational complex at the West Virginia Regional Technology Park and an access road to The Shops at Trace Fork shopping center. The total project should take about 3 years and is expected to be complete in 2022.

Café Appalachia Community Restaurant Opens in South Charleston



Café Appalachia, located at 206 D Street in South Charleston, is a farm-to-table, buffet-style restaurant with suggested-donation pricing. The café also has a coffee shop and offers espressos, cappuccinos, frappuccinos and infused iced teas. Those unable to pay for their meal may donate an hour of their time doing small chores in the café or garden as compensation. Most of the food served

at Café Appalachia is grown in their own urban garden and everything is as locally sourced as possible. The café also serves as an employment training program for individuals in long-term substance abuse recovery. Participants receive training in areas such as agriculture, culinary, barista service food handling and event planning.

Overview for Kanawha County, WV
Part of Charleston WV, Metropolitan Area



Kanawha County is one of about 3,142 counties and county equivalents in the United States. It has 901.6 sq. miles in land area and a population density of 214.1 per square mile. On the most recent census form, 88.6% of the population reported white alone, with 7.6% reporting African American. The population of this county is 1.1% Hispanic (of any race). The average household size is 2.30 persons.

In 2017 health care and social services was the largest of 20 major sectors. It had an average wage per job of \$51,464. Per capita income grew by 24.3% between 2007 and 2017 (adjusted for inflation).

People & Income Overview (By Place of Residence)			Industry Overview, 2017 (By Place of Work)		
	Value	Rank in U.S.		Value	Rank in U.S.
Population (2017)	183,293	356	Covered Employment	99,454	285
Growth (%) since 2010 Census	-5.1 %	2,700	Avg Wage per Job	\$46,531	508
Households (2017)	80,267	308	Manufacturing - % All Jobs in County	3.6 %	2,343
Labor Force (persons) (2017)	84,245	388	Avg Wage per Job	\$69,460	258
Unemployment Rate (2017)	5.0	995	Transportation & Warehousing - % All Jobs in County	3.9%	827
Per Capita Personal Income (2017)	\$45,642	834	Avg Wage per Job	\$65,744	112
Median Household Income (2017)	\$43,598	1,895	Health Care, Social Assist. - % All Jobs in County	19.4%	229
Poverty Rate (2017)	18.1	830	Avg Wage per Job	\$51,464	335
High School Diploma or More - % of Adults 25+ (2017)	88.3%	1,418	Finance and Insurance - % All Jobs in County	4.5 %	254
Bachelor's Degree or More - % of Adults 25+ (2017)	25.3%	1,418	Avg Wage per Job	\$67,650	373

Demographics for Kanawha County, WV

Population over Time	Number	Rank in U.S.	Percent of West Virginia	U.S.
2017	183,293	356	10.1 %	1,815,857
2010	193,063	324	10.4 %	1,852,994
2000	199,743	279	11.1 %	1,806,694
1990	207,339	244	11.6 %	1,792,481
1980	231,414	195	11.9 %	1,950,183
2000 to 2010 % Change	-3.3 %	2,432		2.6 %
1990 to 2010 % Change	-6.9 %	2,659		3.4 %
1980 to 2010 % Change	-16.6 %	2,684		-5.0 %

Source: U.S. Census Bureau

Components of Population Change (1-year change ending in 2017)	Number	Rank in U.S.	Percent of U.S.	West Virginia
Net Domestic Migration	-2,444	3,056	24.2 %	-10,107
Net International Migration	114	584	34.3%	332
Natural Increase (births minus deaths)	-479	3,117	11.7%	-4,082
Births	1,985	376	10.7%	18,547
Deaths	2,464	235	10.9%	22,629

Source: U.S. Census Bureau

Population Estimates by Age in 2017	Number	Rank in U.S.	Pct Dist.	Pct Dist. in U.S.
Preschool (0 to 4)	10,430	372	5.6 %	6.2%
School Age (5 to 17)	27,836	394	14.8 %	16.7%
College Age (18 to 24)	14,567	447	7.8 %	9.7%
Young Adult (25 to 44)	45,910	351	24.4%	26.4%
Older Adult (45 to 64)	53,827	317	28.7%	26.1%
Older (65 plus)	35,257	279	18.8%	14.9%
Median Age	43.1	1,035		Median Age = 37.8

Sources: U.S. Census Bureau; Median age calculated by the IBRC.

Population Estimates by Race and Hispanic Origin in 2017	Number	Rank in U.S.	Pct Dist.	Pct Dist. in U.S.
American Ind. or Alaskan Native Alone	174	1,309	0.1%	0.8%
Asian Alone	1,984	504	1.1 %	5.4%
Black Alone	13,048	445	6.9%	12.7%
Native Hawaiian and Other Pac. Isl. Alone	0	1,730	0.0 %	0.2%
White Alone	166,270	309	88.5%	73.0%
Two or More Race Groups	5,927	319	3.2%	3.1%
Hispanic or Latino (can be of any race)				
Non-Hispanic or Latino	185,845	312	98.9 %	82.4%
Hispanic or Latino	1,982	1,219	1.1 %	17.6%

Sources: U.S. Census Bureau

Hispanic or Latino Population in 2017 (can be of any race)	Number	Rank in U.S.	Pct Dist.	Pct Dist. in U.S.
Hispanic	1,982	1,219	100%	100%
Mexican	599	1,619	30.2%	63.2%
Cuban	233	433	11.8%	3.8%
Puerto Rican	337	736	17.0%	9.6%
Other	813	789	41.0%	23.4%
White, Not Hispanic (reporting white alone)	164,970	276	N/A	N/A

Source: U.S. Census Bureau, American Community Survey, 5-Year Estimates

Education for Kanawha County, WV

Educational Attainment in 2017	Number	Percent of Population 25+	Rank in U.S.	U.S. % of Population 25+
Total Population 25 and Older	134,994	100%	N/A	100%
Less than 9th Grade	4,518	3.3%	2,047	5.4%
9th to 12th, No Diploma	11,293	8.4 %	1,439	7.2%
High School Graduate (includes equiv.)	50,737	37.6%	1,065	27.3%
Some College, No Degree	25,689	19.0%	2,407	20.8%
Associate Degree	8,595	6.4 %	2541	8.3%
Bachelor's Degree	19,988	14.8%	1,125	19.1
Graduate, Professional or Doctorate Degree	14,174	10.5%	535	11.8%

Source: U.S. Census Bureau, American Community Survey, 5-Year Estimates

Income & Poverty for Kanawha County, WV

Median Income	Number	Rank in U.S.	Percent of U.S.
Median Household Income in 2017	\$43,598	2,219	72.3%
Median Household Income in 2000	\$35,414	1,477	84.3%
Percent Change 2000 to 2017	23.1%	2,956	

Source: U.S. Census Bureau

Per Capita Personal Income (PCPI)	Number	Rank in U.S.	Percent of U.S.
2017	\$45,642	834	88.4%
2007	\$36,718	579	92.2%
1997	\$24,921	413	96.0%
1987	\$14,217	850	87.4%
10-Year % Change	24.3%	12	
20-Year % Change	83.1%	1,388	
30-Year % Change	221.0%	202	

Source: U.S. Bureau of Economic Analysis

Personal Income in 2017 (\$000)	Number	5-Year % Change (adj*)	Rank in U.S.
Total Earnings by Place of Work	\$7,034,686	1.1%	2,311
Minus: Contributions for Government Social Insurance	\$864,031	21.4%	2,354
Personal Contributions for Government Social Insurance	\$459,575	37.3%	2,330
Employer Contributions for Government Social Insurance	\$404,456	7.2%	2,110
Plus: Adjustment for Residence	(\$1,581,151)	10.9%	1,815
Equals: Net Earnings by Place of Residence	\$4,589,504	-4.8%	2,592
Plus: Dividends, Rent, Interest	\$1,449,0005	9.3%	2,612
Plus: Transfer Payments	\$2,327,288	17.7%	1,700
Equals: Personal Income by Place of Residence	\$8,365,797	3.0%	2,634

Source: U.S. Bureau of Economic Analysis

Poverty Estimates	Number	Rank in U.S.	Percent Change	Rank in U.S.
Poverty Rate in 2017	18.1	830	--	--
In 2000	13.0	1,392	39.2 %	445
Poverty Rate for Children under 18 in 2017	25.0	969	--	--
In 2000	19.7	1,250	26.9 %	970

Source: U.S. Census Bureau

Jobs & Earnings (BEA) for Kanawha County, WV

BEA Major Sectors (NAICS) in 2017 (by place of work)	Earnings (\$000)	Avg Earnings Per Job	Rank in U.S.	Jobs	Pct Dist. in County	Pct Dist. in U.S.
Earnings by place of work – 35	\$7,034,686	\$55,788	370	126,095	100.0%	100.0%
Wage and salary disbursements - 50	\$5,099,238	\$46,988	529	108,521	86.1%	77.4%
Proprietors' income - 70	\$687,570	\$39,124	318	17,574	13.9%	22.6%
Farm proprietors' income - 71	(\$761)	(\$4,113)	2,138	185	0.1%	0.9%
Nonfarm proprietors' income - 72	\$688,331	\$39,584	222	17,389	13.8%	21.7%
Farm earnings - 81	(\$640)	(\$3,404)	2,504	188	0.1%	1.3%
Nonfarm earnings - 82	\$7,035,326	\$55,877	368	125,907	99.9%	98.7%
Private earnings - 90	\$5,772,930	\$55,481	287	103,151	81.8%	86.2%
Forestry, fishing, related activities, and other - 100	\$2,995	\$31,197	613	96	0.1%	0.5%
Mining - 200	\$220,334	\$45,439	462	4,849	3.8%	0.8%
Utilities - 300	\$86,071	\$127,891	204	673	0.5%	0.3%
Construction - 400	\$391,148	\$73,579	274	5,316	4.2%	5.4%
Manufacturing - 500	\$323,753	\$84,442	287	3,834	3.0%	6.8%
Retail Trade - 700	\$408,872	\$31,278	690	13,072	10.4%	9.8%
Transportation and warehousing - 800	\$266,327	\$79,619	214	3,345	2.7%	3.9%
Information - 900	\$152,093	\$81,420	234	1,868	1.5%	1.7%

Source: U.S. Bureau of Economic Analysis (BEA)

D = Not shown to avoid disclosure of confidential information, but the estimates for this item are included in the totals.

L = Less than 10 jobs, but the estimates for this item are included in the totals.

N/A = Not available or not applicable.

* = "Other" consists of the number of jobs held by U.S. residents employed by international organizations and foreign embassies and consulates in the United States.

Jobs & Wages (BLS) for Kanawha County, WV

Annual Covered Employment and Wages Over Time (NAICS)	Establishments	Jobs	Average Wage Per Job	Rank in U.S.	Pct of U.S. Avg Wage
2017	5,728	99,454	\$46,531	508	84.0%
2016	5,819	101,128	\$45,360	485	108.9%
2015	5,931	102,811	\$44,755	514	107.3%
2014	5,953	103,623	\$43,782	521	106.3%
2013	5,987	103,832	\$42,777	505	106.4%
2012	6,015	105,093	\$42,532	486	107.1%
2011	5,977	105,118	\$42,024	451	107.5%
2010	5,968	105,203	\$40,848	435	108.4%
2009	5,996	105,980	\$40,543	389	109.9%
2008	6,090	108,134	\$39,714	441	110.4%
2007	6,135	108,524	\$38,053	459	111.6%
10-Year Change	-407	-9,070	\$8,478		
10-Year Percent Change	-6.6 %	-8.4 %	22.3 %		

Source: U.S. Bureau of Labor Statistics (BLS)

D = Non-Disclosable Data; **N/A** = Not Available; Note: Average wage may not match published numbers due to rounding.

Annual Industry Distribution of Jobs and Avg. Wage in 2017 (NAICS)	Establishments	Jobs	Pct. Dist.	Annual Average Wage Per Job	Rank in U.S.
Total	5,728	99,454	100.0%	\$46,531	508
Agriculture, Forestry, Fishing and Hunting	12	25	0.0%	\$27,147	1,485
Mining	71	2,133	2.1%	\$81,086	248
Utilities	37	880	0.9%	\$81,307	756
Construction	409	3,634	3.7%	\$62,515	274
Manufacturing	114	3,564	3.6%	\$69,460	258
Wholesale Trade	282	2,748	2.8%	\$60,013	560
Retail Trade	753	11,407	11.5%	\$27,683	789
Transportation & Warehousing	181	3,886	3.9%	\$65,744	112
Information	84	1,744	1.8%	\$55,698	530
Finance and Insurance	327	4,480	4.5%	\$67,650	373
Real Estate and Rental and Leasing	220	1,222	1.2%	\$41,882	583
Professional, Scientific, and Technical Services	612	4,823	4.8%	\$64,661	596
Management of Companies and Enterprises	53	1,128	1.1%	\$76,023	611
Admin. & Support & Waste Mgt. & Rem. Services	301	6,056	6.1%	\$30,779	1,195
Educational Services	127	5,030	5.1%	\$38,988	687
Health Care and Social Services	710	19,281	19.4%	\$51,464	335
Arts, Entertainment, and Recreation	104	1,166	1.2%	\$20,990	797
Accommodation and Food Services	423	8,648	8.7%	\$18,561	430
Other Services (Except Public Administration)	742	2,833	2.8%	\$35,714	380
Public Administration	166	11,845	11.9%	\$46,262	1,144
Unallocated	1	0	0.0%	\$11,844	1,072

Source: U.S. Bureau of Labor Statistics (BLS)

D = Not shown to avoid disclosure of confidential information.

N/A = This item is not available.

Note: Average wage may not match published numbers due to rounding.

Labor Force for Kanawha County, WV

Labor Force Annual Averages in 2017	Number	Rank in U.S.	% of U.S.	U.S.
Total Labor Force	84,245	388	10.8 %	778,821
5-Year % Change	-7.8 %	2,676	--	0.0 %
10-Year % Change	-8.5 %	2,195	--	-4.0 %
Employed	80,029	387	10.8 %	738,309
5-Year % Change	-6.2 %	2,778	--	-1.2 %
10-Year % Change	-9.4 %	2,294	--	-4.6 %
Unemployed	4,216	330	10.4 %	40,512
5-Year % Change	-30.1 %	617	--	-33.1 %
10-Year % Change	14.4 %	600	--	9.0 %
Unemployment Rate	5.0	995	96.2 %	5.2
5-Year % Change	-24.2 %	492	--	-30.7 %
10-Year % Change	25.0 %	380	--	13.0 %

Source: U.S. Bureau of Labor Statistics

Living Arrangements for Kanawha County, WV

Households in 2017	Number	Rank in U.S.	Pct. Dist.	Pct. Dist. in U.S.
Total Households	80,267	308	100%	100%
Family Households	50,303	325	62.7%	65.9%
Married with Children	11,277	406	14.0%	19.1%
Married without Children	24,310	309	30.3%	29.2%
Single Parents	7,792	283	9.7%	9.1%
Other	6,924	271	8.6%	8.4%
Non-Family Households	29,964	281	37.3%	34.1%
Living Alone	25,645	267	31.9%	27.7%
Average Household Size	2.30	2,112		

Source: U.S. Census Bureau

Housing Units in 2017	Number	Rank in U.S.	Pct. Dist.	Pct. Dist. in U.S.
Total Housing Units (ACS estimate)	92,487	304	100%	100%
Occupied	80,267	308	68.8%	87.8%
Owner Occupied	55,469	304	60.0%	56.0%
Renter Occupied	24,798	319	26.8%	31.8%
Vacant	12,220	273	13.2%	12.2%
For Seasonal or Recreational Use	951	972	1.0%	4.0%

Source: U.S. Census Bureau

Residential Building Permits in 2017	Units	Pct Dist.	Pct Dist. in U.S.	Cost (\$000)
Total Permits Filed	125	100%	100%	\$16,557
Single Family	60	48.0%	64.0%	\$11,830
Two Family	10	8.0%	1.5%	\$1,179
Three and Four Family	16	12.8%	1.4%	\$1,083
Five Families and More	39	31.2%	33.1%	\$2,465

Source: U.S. Census Bureau



StatsAmerica is a service of the [Indiana Business Research Center](#) at Indiana University's Kelley School of Business. This initiative is funded in part by the U.S. Commerce Department's [Economic Development Administration](#).

Top 10 Employers in Kanawha County

1. Charleston Area Medical Center, Inc.
2. Kanawha County Board of Education
3. Thomas Health Systems
4. West Virginia Department of Health and Human Resources
5. Blackhawk Mining, LLC
6. Wal-Mart Associates, Inc.
7. West Virginia Department of Highways
8. Kroger
9. United States Postal Service
10. City of Charleston

Source: Workforce WV, March 2019

PUTNAM COUNTY



Winfield Locks and Dam



Valley Park Conference Center

Putnam County lies within the Allegheny Plateau. The Kanawha River Valley bisects Putnam County from southeast to northwest and provides much of the flat land used for development in the area. Putnam County is located between West Virginia’s two largest cities – Charleston and Huntington. The mean annual precipitation is 42 inches; snowfall averages 32 inches per year. There are six (6) municipalities in Putnam County. They are Bancroft, Buffalo, Eleanor, Hurricane, Poca and Winfield. Also, a portion of Nitro is located in Putnam County.

Distance to Major Cities from Winfield

Atlanta.....	534 miles
Chicago.....	469 miles
Cincinnati.....	180 miles
Cleveland.....	275 miles
Columbus.....	200 miles
Lexington.....	170 miles
New York.....	570 miles
Pittsburgh.....	257 miles
Washington, DC.....	365 miles

TRANSPORTATION

Highways

Putnam County is served by Interstate 64, which provides service from St. Louis MO to Richmond, VA, by US Routes 35 and 60 & WV Routes 34 and 62.

Completed or Planned Highway Improvements:

Interstate 64 Widening:

- Widening to six lanes from Crooked Creek to Nitro

New US 35 alignment in Putnam County: Construct four lane median-divided highway between the Johnathon David Higginbotham Memorial Bridge (CR 869) to the Mason County line.

Funding Source: FHWA and WVDOT

Cost: \$98.4 million

Culloden Interchange:

- New Entrance/Exit Ramp along Interstate 64
- Located primarily in Cabell County, but connector roads and ramps will be in Putnam County.

Public Transportation

Bus Service is provided by KVRTA through a small portion of Putnam County through Nitro Marketplace. Taxi service is available through Teays Valley Taxi.

Rail Service

Freight service is provided by CSX and Northern Southern. Amtrak service traverses the County, but the nearest stations are in Huntington and Charleston.

Air Service

Air service in Putnam County is provided by Yeager Airport, located in downtown Charleston.

UTILITIES

Water

Water is provided to Putnam County residents by American Water, Putnam PSD and the City of Hurricane.

Electric

American Electric Power (AEP) provides electricity.

Gas and Other

Natural gas is provided by Mountaineer Gas.

Economy

Putnam County is the fastest growing county in the region and the most affluent with a median household income in 2016 of \$56,789. Putnam County has the advantage of being located between Charleston and Huntington and is connected by interstate highway to both cities. It is also endowed with a relatively large amount of flat developable land, both in the Teays Valley area and in the Kanawha River Valley. The recent 4-laning of U.S. 35 from I-64 to Buffalo (including a new I-64 interchange) has boosted economic development potential.

Teays Valley is mostly a mix of residential, retail and service development. Additional industrial, retail and service establishments can be found in the following industrial and business parks:

- Eleanor Industrial Park, Eleanor
- Par Industrial Park, Nitro
- HUB Industrial Park, Nitro
- Rock Branch Industrial Park, Poca

- Putnam Business Park, Fraziers Bottom
- Teays Valley Industrial Park, Scott Depot

American Electric Power Expanding in Hurricane



American Electric Power (AEP) is expanding in Hurricane. AEP is in the process of building a transmission service center near the Hurricane interstate exit. The transmission center will bring more than 130 jobs

to Hurricane and will also give AEP room to expand in the future. The new facility will be 85,00 square feet with a project cost of \$27 million. Construction is scheduled to be finished in 2020.

New Dual Hotel Under Construction in Teays Valley



Construction is underway on a dual Choice Hotel brand just off Interstate 64 at the Teays Valley exit. Sleep Inn will offer the amenities that short-term guests need, while the Main-Stay Suites will cater to extended-stay guests. Combined both hotels will offer 74 rooms and are expected to bring 20 to 25 new jobs to the area. Franchise owner Harding Hospitality

hopes this development will continue to bring even more restaurants and tourism to the Teays Valley area.

Courtyard Cakeries & Restaurant Opens at Valley Park



Courtyard Cakeries & Restaurant is a new bakery and restaurant located in the commons at Valley Park in Hurricane. In their bakery they have an assortment of handcrafted baked goods, ice cream, milkshakes and chocolate covered fruit. The restaurant is open daily with a menu that includes

salads, sandwiches and hamburgers, with feature dinner specials served on Friday and Saturday nights. They also host parties, cater events and do custom orders for weddings, showers and meetings.

The Center on Main Street Hurricane



The Center is a multicultural and multifaceted art, music and gaming location that opened in January on Main Street in Hurricane. Geno DeMay opened The Center to provide a community space for instruction, interaction and entertainment. The Center offers full-year memberships for \$12 or monthly memberships for \$2. Visitors can browse and shop at no charge but must have a membership to attend special events. The Center also maintains its own YouTube channel where members can submit ideas for shows and produce them. Regular activities already taking place at The Center include Friday Night Magic, Saturday Pokémon and Family Game Day with Pinewood Derby drag racing. The facility hosts birthday parties and has a kitchen with snacks and drinks available. A stage is also being developed to host musicians, DJ's, dances and performers.

Old Mill Bakery Now Open in Hurricane



Old Mill Bakery owned by Lynn Bright opened for business in December on Morris Court in downtown Hurricane. The bakery serves made-from-scratch brownies, cookie hybrid brookies, cow chip cookies, peanut butter pie, cinnamon rolls, breads and more. They also accept custom orders for cakes and have a party room that they rent out. The Old Mill bakery also contains a small historical museum of Hurricane. Along with expanding the museum, Ms. Bright also plans to offer community-oriented events and classes at the Old Mill Bakery

Overview for Putnam County, WV

Part of Charleston WV, Metropolitan Area

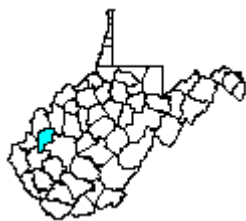

Putnam County is one of about 3,142 counties and county equivalents in the United States. It has 344.64 sq. miles in land area and a population density of 160.5 per square mile. On the most recent census form, 96.6% of the population reported white alone, with 1.1% of the population reporting African American and 1.1% Hispanic (of any race). The average household size is 2.59 persons.

In 2017 manufacturing was the largest of 20 major sectors. It had an average wage per job of \$68,797. Per capita income grew by 31.6% between 2007 and 2017 (adjusted for inflation).

People & Income Overview (By Place of Residence)	Value	Rank in U.S.	Industry Overview, 2016 (By Place of Work)	Value	Rank in U.S.
Population (2017)	56,792	905	Covered Employment	20,004	894
Growth (%) since 2010 Census	2.4 %	961	Avg Wage per Job	\$48,888	377
Households (2017)	21,734	895	Manufacturing - % All Jobs in County	12.1%	1,215
Labor Force (persons) (2017)	26,006	905	Avg Wage per Job	\$68,797	270
Unemployment Rate (2017)	4.7	1,215	Transportation & Warehousing - % All Jobs in County	4.9%	544
Per Capita Personal Income (2017)	\$44,279	988	Avg Wage per Job	\$56,622	307
Median Household Income (2017)	\$59,815	609	Health Care, Social Assist. - % All Jobs in County	9.9%	1,434
Poverty Rate (2017)	10.4	2,469	Avg Wage per Job	\$49,265	442
High School Diploma or More - % of Adults 25+ (2017)	91.9%	593	Finance and Insurance - % All Jobs in County	2.3%	1,376
Bachelor's Degree or More - % of Adults 25+ (2017)	24.9%	593	Avg Wage per Job	\$63,245	485

Demographics for Putnam County, WV

Population over Time	Number	Rank in U.S.	Percent of West Virginia	West Virginia
2017	56,792	905	3.1 %	1,815,857
2010	55,486	907	3.0 %	1,852,994
2000	51,713	916	2.9 %	1,806,694
1990	43,017	957	2.4 %	1,792,481
1980	38,181	1,001	2.0 %	1,950,183
2000 to 2010 % Change	7.3 %	1,015		2.6 %
1990 to 2010 % Change	29.0 %	754		3.4 %
1980 to 2010 % Change	45.3 %	687		-5.0 %

Source: U.S. Census Bureau

Components of Population Change (1-year change ending in 2017)	Number	Rank in U.S.	Percent of West Virginia	West Virginia
Net Domestic Migration	96	975	-0.9 %	-10,107
Net International Migration	14	1,463	4.2%	332
Natural Increase (births minus deaths)	-6	2,060	0.1%	-4,082
Births	584	976	3.1 %	18,547
Deaths	590	877	2.6%	22,629

Source: U.S. Census Bureau

Population Estimates by Age in 2017	Number	Rank in U.S.	Pct Dist.	Pct Dist. in U.S.
Preschool (0 to 4)	3,271	914	5.8%	6.2%
School Age (5 to 17)	9,638	879	17.0%	16.7%
College Age (18 to 24)	3,900	1,102	6.9%	9.7%
Young Adult (25 to 44)	14,231	873	25.1%	26.4%
Older Adult (45 to 64)	16,128	868	28.5 %	26.1%
Older (65 plus)	9,476	906	16.7%	14.9%
Median Age	41.6	1,448		Median Age = 37.8

Sources: U.S. Census Bureau; Median age calculated by the IBRC.

Population Estimates by Race and Hispanic Origin in 2017	Number	Rank in U.S.	Pct Dist.	Pct Dist. in U.S.
American Ind. or Alaskan Native Alone	90	1,728	0.2%	0.8%
Asian Alone	324	1,106	0.6%	5.4%
Black Alone	694	1,728	1.2%	12.7%
Native Hawaiian and Other Pac. Isl. Alone	12	1,258	0.0 %	0.2%
White Alone	54,614	821	96.4%	73.0%
Two or More Race Groups	749	1,251	1.3%	3.1%
Hispanic or Latino (can be of any race)				
Non-Hispanic or Latino	56,015	852	98.9 %	82.4%
Hispanic or Latino	629	1,902	1.1 %	17.6%

Sources: U.S. Census Bureau

Hispanic or Latino Population in 2017 (can be of any race)	Number	Rank in U.S.	Pct Dist.	Pct Dist. in U.S.
Hispanic	629	1,902	100%	100%
Mexican	511	1,729	81.2%	63.2%
Cuban	48	977	7.6%	3.8%
Puerto Rican	25	1,927	4.0%	9.6%
Other	45	2,341	7.2%	23.4%
White, Not Hispanic (reporting white alone)	54,072	777	N/A	N/A

Source: U.S. Census Bureau, American Community Survey, 5-Year Estimates

Education for Putnam County, WV

Educational Attainment in 2017	Number	Percent of Population 25+	Rank in U.S.	U.S. % of Population 25+
Total Population 25 and Older	39,835	100%	N/A	100%
Less than 9th Grade	1,184	3.0%	2,215	5.4%
9th to 12th, No Diploma	2,048	5.1 %	2,565	7.2%
High School Graduate (includes equiv.)	15,122	38.0%	993	27.3%
Some College, No Degree	7,908	19.9%	2,156	20.8%
Associate Degree	3,643	9.1%	1,254	8.3%
Bachelor's Degree	5,997	15.1%	1,056	19.1%
Graduate, Professional or Doctorate Degree	3,933	9.9%	613	11.8%

Source: U.S. Census Bureau, American Community Survey, 5-Year Estimates

Income & Poverty for Putnam County, WV

Median Income	Number	Rank in U.S.	Percent of U.S.
Median Household Income in 2017	\$59,815	609	99.1%
Median Household Income in 2000	\$43,512	508	103.6 %
Percent Change 2000 to 2017	37.5%	1,779	

Source: U.S. Census Bureau

Per Capita Personal Income (PCPI)	Number	Rank in U.S.	Percent of U.S.
2017	\$44,279	988	85.7%
2007	\$33,650	962	84.5%
1997	\$22,492	841	86.7%
1987	\$12,719	1,559	78.2%
10-Year % Change	31.6%	13	
20-Year % Change	96.9 %	1,388	
30-Year % Change	248.1	202	

Source: U.S. Bureau of Economic Analysis

Personal Income in 2017 (\$000)	Number	5-Year % Change (adj*)	Rank in U.S.
Total Earnings by Place of Work	\$1,496,304	9.7%	1658
Minus: Contributions for Government Social Insurance	\$196,974	32.2%	1,137
Personal Contributions for Government Social Insurance	\$102,283	49.7%	1,226
Employer Contributions for Government Social Insurance	\$94,691	17.4%	958
Plus: Adjustment for Residence	\$394,101	11.8%	1,759
Equals: Net Earnings by Place of Residence	\$1,693,431	8.0%	1,748
Plus: Dividends, Rent, Interest	\$325,703	8.6%	2,661
Plus: Transfer Payments	\$495,569	18.8%	1,484
Equals: Personal Income by Place of Residence	\$2,514,703	10.1%	1,991

Source: U.S. Bureau of Economic Analysis

Poverty Estimates	Number	Rank in U.S.	Percent Change	Rank in U.S.
Poverty Rate in 2017	10.4	2,469	--	--
In 2000	8.6	2,527	20.9 %	1,305
Poverty Rate for Children under 18 in 2017	12.2	2,692	--	--
In 2000	11.4	2,568	7.0 %	2,207

Source: U.S. Census Bureau

Jobs & Earnings (BEA) for Putnam County, WV

BEA Major Sectors (NAICS) in 2017 (by place of work)	Earnings (\$000)	Avg Earnings Per Job	Rank in U.S.	Jobs	Pct Dist. in County	Pct Dist. in U.S.
Earnings by place of work - 35	\$1,496,304	\$53,994	454	27,712	100.0%	100.0%
Wage and salary disbursements - 50	\$1,111,127	\$50,145	349	22,158	80.0%	77.4%
Proprietors' income - 70	\$131,130	\$23,610	1,203	5,554	20.0%	22.6%
Farm proprietors' income - 71	(\$2)	(\$4)	1,806	474	1.7%	0.9%
Nonfarm proprietors' income - 72	\$131,132	\$25,813	1,011	5,080	18.3%	21.7%
Farm earnings - 81	\$2,825	\$5,155	1,908	548	2.0%	1.3%
Nonfarm earnings - 82	\$1,493,479	\$54,980	406	72,164	98.0%	98.7%
Private earnings - 90	\$1,350,867	\$4,886	307	24,612	88.8%	86.2%

Forestry, fishing, related activities, and other - 100	\$1,146	\$42,444	293	27	0.1%	0.5%
Mining - 200	\$2,795	\$11,502	1,083	243	0.9%	0.8%
Utilities - 300	\$59,801	\$138,428	125	432	1.6%	0.3%
Construction - 400	\$216,819	\$75,546	237	2,870	10.4%	5.4%
Manufacturing - 500	\$209,872	\$83,881	302	2,502	9.0%	6.8%
Retail Trade – 700	&84.833	\$27,650	1,365	3,068	11.1%	9.8%
Transportation and warehousing - 800	\$74,620	\$64,161	503	1,163	4.2%	3.9%
Information - 900	\$14,665	\$65,177	466	225	0.8%	1.7%

Source: U.S. Bureau of Economic Analysis (BEA)

D = Not shown to avoid disclosure of confidential information, but the estimates for this item are included in the totals.

L = Less than 10 jobs, but the estimates for this item are included in the totals.

N/A = Not available or not applicable.

* = "Other" consists of the number of jobs held by U.S. residents employed by international organizations and foreign embassies and consulates in the United States.

Jobs & Wages (BLS) for Putnam County, WV

Annual Covered Employment and Wages Over Time (NAICS)	Establishments	Jobs	Average Wage Per Job	Rank in U.S.	Pct of U.S. Avg Wage
2017	1,475	20,004	&48,888	377	88.3%
2016	1,477	20,502	\$47,850	360	89.2%
2015	1,465	20,272	\$46,553	419	87.9%
2014	1,450	19,847	\$46,011	405	89.6%
2013	1,443	19,826	\$45,036	374	90.4%
2012	1,443	19,818	\$44,666	354	90.6%
2011	1,399	18,906	\$46,658	231	97.1%
2010	1,373	19,054	\$43,266	300	92.5%
2009	1,359	19,266	\$43,108	266	94.6%
2008	1,360	20,796	\$42,001	320	92.2%
2007	1,372	19,484	\$40,326	320	90.7%
10-Year Change	103	520	\$8,562		
10-Year Percent Change	7.5%	2.7%	21.2%		

Source: U.S. Bureau of Labor Statistics (BLS)

D = Non-Disclosable Data; **N/A** = Not Available; Note: Average wage may not match published numbers due to rounding.

Annual Industry Distribution of Jobs and Avg. Wage in 2017 (NAICS)	Establishments	Jobs	Pct. Dist.	Annual Average Wage Per Job	Rank in U.S.
Total	1,475	20,004	100.0%	\$48,888	377
Agriculture, Forestry, Fishing and Hunting	7	83	0.4%	\$21,431	1,671
Mining	6	20	0.1%	\$85,344	187
Utilities	10	415	2.1%	\$104,891	228
Construction	186	2,048	10.2%	\$62,613	271
Manufacturing	48	2,427	12.1%	\$68,797	270
Wholesale Trade	99	1,456	&.3%	\$59,143	607
Retail Trade	165	2,356	11.8%	\$28,435	621
Transportation & Warehousing	77	985	4.9%	\$56,622	307
Information	18	169	0.8%	\$59,882	397

Finance and Insurance	89	460	2.3%	\$63,245	485
Real Estate and Rental and Leasing	57	418	2.1%	\$47,750	357
Professional, Scientific, and Technical Services	128	851	4.3%	\$58,878	832
Management of Companies and Enterprises	20	206	1.0%	\$91,369	391
Admin. & Support & Waste Mgt. & Rem. Services	82	1,451	7.3%	\$42,886	296
Educational Services	35	1,249	6.2%	\$46,507	22
Health Care and Social Services	143	1,987	9.9%	\$49,265	442
Arts, Entertainment, and Recreation	24	291	1.5%	\$13,081	1,890
Accommodation and Food Services	96	1,703	8.5%	\$14,989	1,137
Other Services (Except Public Administration)	156	484	2.4%	\$32,405	697
Public Administration	28	580	2.9%	\$38,128	1,833
Unallocated	3	2	0.0%	\$12,897	1,003

Source: U.S. Bureau of Labor Statistics (BLS), D = Not shown to avoid disclosure of confidential information.
N/A = This item is not available., Note: Average wage may not match published numbers due to rounding.

Labor Force for Putnam County, WV

Labor Force Annual Averages in 2017	Number	Rank in U.S.	% of U.S.	U.S.
Total Labor Force	26,006	905	3.3 %	778,821
5-Year % Change	-1.4 %	1,617	--	0.0 %
10-Year % Change	-5.3 %	1,835	--	-4.08 %
Employed	24,738	906	34 %	738,309
5-Year % Change	0.4 %	1,942	--	-01.2 %
10-Year % Change	-6.3 %	1,992	--	-4.6 %
Unemployed	1,223	880	3.0 %	40,512
5-Year % Change	-27.8 %	505	--	-33.1 %
10-Year % Change	19.7 %	438	--	9.0 %
Unemployment Rate	4.7	1,215	90.4 %	5.2
5-Year % Change	-26.6%	583	--	-30.7 %
10-Year % Change	27.0 %	347	--	13.0 %

Source: U.S. Bureau of Labor Statistics

Living Arrangements for Putnam County, WV

Households in 2017	Number	Rank in U.S.	Pct. Dist.	Pct. Dist. in U.S.
Total Households	21,734	895	100%	100%
Family Households	15,415	865	70.9%	65.9%
Married with Children	4,931	748	22.7%	19.1%
Married without Children	7,586	863	34.9%	29.2%
Single Parents	1,649	1,010	7.6%	9.1%
Other	1,249	1,093	5.7%	8.4%
Non-Family Households	6,319	963	29.1%	34.1%
Living Alone	5,543	934	25.5%	27.7%
Average Household Size	2.50	934		

Source: U.S. Census Bureau

Housing Units in 2017	Number	Rank in U.S.	Pct. Dist.	Pct. Dist. in U.S.
Total Housing Units (ACS estimate)	23,978	960	100%	100%
Occupied	21,734	895	90.6%	87.8%
Owner Occupied	17,667	811	73.7%	56.0%
Renter Occupied	4,067	1,220	17.0%	31.8%
Vacant	2,244	1,474	9.4%	12.2%
For Seasonal or Recreational Use	200	2,232	0.8%	4.0%

Source: U.S. Census Bureau

Residential Building Permits in 2017	Units	Pct Dist.	Pct Dist. in U.S.	Cost (\$000)
Total Permits Filed	93	100%	100%	\$20,795
Single Family	93	100%	64.0%	\$20,795
Two Family	0	0.0%	1.5%	\$0
Three and Four Family	0	0.0%	1.4%	\$0
Five Families and More	0	0.0 %	33.1%	\$0

Source: U.S. Census Bureau



StatsAmerica is a service of the [Indiana Business Research Center](#) at Indiana University's Kelley School of Business. This initiative is funded in part by the U.S. Commerce Department's [Economic Development Administration](#).

Top 10 Employers in Putnam County

1. Putnam County Board of Education
2. Toyota Motor Manufacturing, West Virginia, Inc.
3. Appalachian Power Company
4. Manpower of West Virginia, Inc.
5. Charleston Area Medical Center, Inc.
6. Wal-Mart Associates, Inc.
7. Apex Pipeline Services, Inc.
8. Nitro Electric Company, Inc.
9. Brand Energy Services, LLC
10. Putnam County Commission

Source: Workforce WV, March 2019

SWOT Analysis

Strengths, Weaknesses, Opportunities and Threats

SWOT Analysis Participation

The CEDS Advisory Committee and Economic Development Agencies in Boone, Clay, Kanawha and Putnam Counties participated in this SWOT analysis.

FY 2019 -2023 CEDS Advisory Committee

Tim Hanna, Putnam County Commission

Kris Mitchell, Boone County Development Authority

Andrew Dunlap, Putnam County Development Authority

Kim Reed, Nitro Development Authority

Anne Barth, TechConnect WV

Chris Ferro, Charleston Area Alliance

S.K. Miller, Retired, Workforce Investment Board

D. Anne Cavalier, Cavalier Business Development

Connie Kinder, Clay County Commission

Lee Roberts, Tornado Products

Wyatt Hanna, South Charleston Attorney

Joy Underwood, Danville Motor Inn

Mark Sankoff, Potesta Engineering

Katy Mallory, Steptoe & Johnson

SWOT Analysis at a Glance

<p>Strengths</p> <ol style="list-style-type: none">1. Transportation Access2. Abundant Workforce3. Diversity of Industry and Business4. Natural Resources5. Education6. WV Regional Technology Park	<p>Opportunities</p> <ol style="list-style-type: none">1. Bank Loans and Grants for Businesses2. Out of Country or State Investors3. Re-employment of Idle Workforce4. Shale Gas Industry5. Health Care6. Startup Businesses in Technology
<p>Weaknesses</p> <ol style="list-style-type: none">1. Lack of Developable Building Sites2. Layoff of Workers3. Lack of Infrastructure	<p>Threats</p> <ol style="list-style-type: none">1. Local Businesses Shutting Down2. Workforce Readiness3. Lack of Capital4. Opioid Epidemic

Strengths

- 1. Transportation Access.** Regional Access in the Kanawha-Putnam area is provided by three major Interstate facilities and three major US facilities: I-64, I-77, I-79, US 35, US 60, and US 119. These routes serve to connect the region to Huntington, Morgantown, Parkersburg, and Beckley in West Virginia; Dayton, Columbus, and Cleveland in Ohio; Lexington, Kentucky; Roanoke and Richmond, Virginia; and Winston-Salem in North Carolina.

Interstate 64 is an east-west Interstate freeway with current termini in Lake Wentzville, Missouri in the west and Chesapeake, Virginia in the east. There are 184 miles of Interstate 64 within the state of West Virginia. The facility connects Huntington, Charleston, Beckley, and Lewisburg within the state.

Interstate 77 is a north-south Interstate freeway with current termini in Columbia, South Carolina in the south and Cleveland, Ohio in the north. The facility is a toll road for 88 miles of its 186 miles within the state of West Virginia and shares its alignment with Interstate 64 between Beckley and Charleston. I-77 connects Beckley, Charleston, Princeton, Bluefield and Parkersburg within the state.

Interstate 79 is a north-south Interstate freeway with current termini in Charleston, West Virginia to the south and Erie, Pennsylvania to the north. Approximately 160 miles of this facility traverses West Virginia, and it connects Charleston to Clarksburg, Fairmont, and Morgantown within the state and Pittsburgh, Pennsylvania outside of the state.

US 35 is a north-south US Highway connecting Charleston through the southern portion of Ohio to Michigan City, Indiana. US 35 connects to Interstate 75 and Interstate 70 in the Dayton, Ohio area. The route has been relocated in Putnam and Mason Counties to a new four-lane facility.

US 60 is a major east-west US highway, stretching over 2,600 miles between Quartzsite, Arizona and Virginia Beach, Virginia. Within the state of West Virginia, the route connects Huntington, Charleston and Lewisburg.

US 119 connects Pikeville, Kentucky to Sandy Township, Pennsylvania. The facility is known primarily as Corridor G and serves as a major connection between the residential and commercial areas south of Charleston and the downtown. Appalachian Corridor G begins in

Williamson, on the Kentucky State line and ends at MacCorkle Avenue.
(Source: RIC's 2040 Long Range Transportation Plan)

A navigable river, the Kanawha, supports economic development in Region III. The U.S. Army Corps of Engineers maintains navigation channel 300 feet wide and nine feet deep in the Kanawha River, which flows through Putnam and Kanawha Counties in Region III. Waterborne commerce has tripled on the Kanawha River in the last thirty years. The cargoes transported on the Kanawha include coke and coal, salt brine, sand and gravel, oil and gas, iron and steel and miscellaneous products. The Marmet Locks and Dam now has twin 56'x360' lock chambers which expedites transporting cargo. The Winfield Locks in Putnam County is able to accommodate nine huge barges at a time.

Rail service is available for commercial and industrial usage. The rail lines link Region III to all United States market areas. Norfolk Southern and CSX Systems handle the major freight needs of coal, chemical and other industries.

Yeager Airport in Charleston provides air service in the Region. Yeager provides non-stop flights to eight different cities: Charlotte, Houston, Philadelphia, Atlanta, Chicago, Washington DC, Myrtle Beach and Ft. Lauderdale.

- 2. Abundant Workforce.** A strong work ethic is one of the major factors that attracted companies more than seventy years ago and continues to be an important consideration for new businesses. The Region offers trained production supervisors; chemists; chemical technicians; plant and equipment operators; molding, forming and extrusion machine operators; machinists and industrial mechanics.

Region III, as well as the entire state of West Virginia, is developing a national reputation for its training programs and workers who are committed to getting the job done. West Virginia is below the national average for employee turnover rates across all industries and has the nation's lowest rate for turnover in manufacturing industries. Employee turnover among all industries in West Virginia is 8.9 percent compared to a national average of 9.4 percent. National benchmark studies show that our region's workforce is among the most productive in the nation, and training programs are structured so that they help business owners get in the best possible position to be successful. Welders, electricians and machinists, once called blue-collar workers, are now at the top of their fields, and are paid very well. Among them, is the Governor's Guaranteed Work Force Program (GGWFP) that provides new and expanding businesses with technical and financial assistance to train, retrain or

upgrade the skills of their employees. The program emphasizes employee training designed to accommodate the needs of individual employers. The GGWFP works closely with education and industry to provide the most advanced knowledge possible. In fiscal year 2017, the GGWFP enabled 2,285 workers to receive training and provided over \$1,120,000 to improve the quality of our workforce. Since the program's launch, more than \$54 million has been awarded to employers and nearly 200,000 employees have received training.

Companies such as Toyota in Buffalo (Putnam County) have partnered with BridgeValley Community and Technical College to begin a program called "Advanced Manufacturing Technician" or AMT. This education-to-work program will give students hands-on experience in manufacturing while they earn a two-year degree. Other community and technical colleges are developing programs for students to train for jobs that are in demand and to help connect companies with students to do those jobs. These programs also extend into West Virginia's high schools.

3. Diversity of Industry and Businesses. The number of industries and businesses reflect the diversity of the Region.

The motor vehicle parts and equipment cluster is one of the fastest growing sectors of the West Virginia economy. Businesses that supply and support the automotive industry find a ready workforce with the necessary skills for today's market. West Virginia's workforce has earned a reputation for high productivity with a low turnover rate in manufacturing industries. NGK Spark Plugs, located in Sissonville, came to West Virginia in 1995 as one of the first Japanese automotive component manufactures. The Sissonville plant began producing oxygen sensors, then adding spark plugs to its production line in 2008. Toyota Motor Manufacturing West Virginia broke ground in Buffalo in 1996 and has expanded nine times. To date the Toyota Buffalo plant represents a \$1.4 billion total investment and directly employs roughly 1,600 people. The auto ignition coil manufacturer Diamond Electric began operations in Eleanor in 1997. Gestamp West Virginia opened a modern stamping facility in South Charleston in 2012. Nippon thermostat also announced a multi-million-dollar expansion in 2012. Between 2006 and 2016 the number of automotive industry jobs in West Virginia increased by 47.6 percent. Industry experts expect the economies of emerging markets will continue to drive up growth in auto parts manufacturing during the next several years.

The Chemical Alliance Zone (CAZ) was created in 1999 to channel and leverage efforts to strengthen our local chemical industry. A nonprofit

collaborative of citizens, labor leaders, educators, government officials, chemical executives and business leaders, the CAZ is dedicated to maintaining and expanding the business of chemistry throughout West Virginia. Using a synergistic approach, the CAZ promotes the region to chemical companies, businesses that use their products and entities that produce related consumer-end goods. Companies seeking a new site to expand, relocate or build new facilities will discover that CAZ offers a promising future based on a long history of success.

A variety of research and development-oriented firms are locating at the WV Regional Technology Park to capitalize on the research environment. Their presence and capabilities can support research and development and product introduction plans. Long-term arrangements include sale or lease of property, shared investments and joint ventures for new products.

The region, particularly the Kanawha Valley has diversified its economy in recent decades. Although still an important chemical manufacturing location, the Charleston area serves as a regional center for health care and professional services. The existence of two universities and a community college, as well as the seat of state government, provides additional economic stability.

- 4. Natural Resources.** The region is rich in natural resources, such as coal, natural gas, oil and timber. Coal and natural gas are available as commodities as well as for use in the chemical, other manufacturing and electrical generation industries. The Kanawha River supplies cheap, reliable transportation, primarily for coal. Historically, salt was an important resource and gave rise to the region's chemical industry. The abundance of sand resulted in a thriving glass industry for a time.

Other natural resources, such as forests, scenic beauty and fishable streams, are important "quality of life" factors. These make the region a more desirable place to live, indirectly supporting economic development.

- 5. Education.** The region has five fully accredited colleges and universities offering quality undergraduate and graduate degree programs. Charleston hosts a branch campus of West Virginia University that serves as a clinical campus for the university's medical and dental schools. Students at either school must complete their class work at the university's main campus in Morgantown, however, they can complete their clinical rotations at hospitals in Charleston. Charleston is also home to a 2,425-student private college, the University of Charleston. Located within the immediate area are: West Virginia State University in Institute;

BridgeValley Community and Technical College with campuses in South Charleston and Montgomery, and Marshall University's South Charleston campus. The region is also home to the Charleston branch of the Robert C. Byrd Institute for Advanced Flexible Manufacturing, an independent program administered by Marshall University.

Southern West Virginia Community and Technical College and the Boone Career and Technical Center, located just off Corridor G (US 119) near Danville, combines a community college and technical school on the same campus.

In Putnam County, at Marshall University's Teays Valley branch, students can take a variety of undergraduate and graduate classes. Strayer University also has a Teays Valley campus that is located off Exit 39 on I-64.

Individuals living in or around Clay County also have access to the Valley Fork Education Center, only five minutes off of Interstate 79, where programs are offered for the fastest growing careers in West Virginia – healthcare, energy and business technology. The facility, once the home of the Valley Fork Elementary School, and operated through the Kanawha Valley Community and Technology College, opened for college students in the fall of 2008.

- 6. WV Regional Technology Park.** The West Virginia Regional Technology Park (Tech Park) in South Charleston is the newest research, education and technology campus in West Virginia's higher education system.

The facility has a history of research and technological contributions, having been established by the Dow Chemical predecessor, Union Carbide Corporation, as the company's primary research center in 1949. Now operated by the West Virginia's Higher Education Policy Commission, the Tech Park adds significant capacity to the state's academic, research and economic development missions. The diversified research, development and commercialization park focuses on chemicals, energy and related technologies for the advancement of education and economic development in the region, as well as West Virginia. Plans for the Tech Park are aimed at transforming investments in higher education and research into business and economic growth.

WEAKNESSES

- 1. Lack of Developable Business Sites.** The topography and lack of utilities limit availability of developable land in our region. Our state's mountains provide a beautiful backdrop for some of the most beautiful scenery in the world, but it is an obstacle. West Virginia's geography, especially in our region, can be characterized commonly as a valley between 100 yards and a half mile with a road, a river and a railroad running along it. Most of this valley is in the flood plain. On either side of this valley are mountain ridges with steep slopes of more than 60 degrees – in other words, flat, easily developable land that isn't subject to frequent flooding is in very short supply.

Much of the new construction occurs on hills to avoid flood hazards. Doing site preparation work for such sites is significantly higher in cost due to the need of moving a lot of earth. Building a four-lane highway requires frequent road cuts (cutting a path through the mountain, etc.). Whether building a school, factory or shopping center, it first requires moving earth to create a footprint for the facility. This added cost places a large burden on communities that want to build and diversify their economies by developing sites and infrastructure. Many are left without access to outside investment and must look for either local sources of funding or for some form of government assistance such as bonds or tax incentives.

- 2. Layoff of Workers.** The weak national economy, as well as changes in specific industries, have resulted in layoffs, notably in the coal mining industry and manufacturing. It is important that the economy be able to absorb these workers, both through expansion in other sectors and re-training.
- 3. Lack of infrastructure.** Infrastructure continues to be problematic for our region and state. There are more structurally deficient and functionally obsolete bridges than on the national average. Our climate and harsh winters are key contributors to the decay, but also the lack of proper maintenance, repair and replacement contribute as well. The main obstacle has been funding. Investment in infrastructure has steadily declined in West Virginia in terms of capital expenditures for new construction of roads and bridges. The road bond referendum that approved the sale of up to 1.6 billion in state bonds on October 7, 2017 is hoped to play a big part in improving the infrastructure in West Virginia. The bonds will be used to repair and replace obsolete bridges and roads and is hoped to help rebuild the infrastructure and the economy in West Virginia. Having a healthy and functioning infrastructure helps to drive the

economy and improves the quality of life. A working infrastructure is key to economic success.

In today's world, access to high-speed Internet or broadband is crucial. More and more commerce is taking place on-line, and access to broadband can level the playing field between rural and non-rural communities when it comes to economic development. Unfortunately, some of our region and West Virginia lags behind the nation when it comes to accessibility to this important utility. Rural communities need access to affordable and accessible universal high-speed Internet just as they do to other infrastructure such as roads, bridges and telephone service. Increased broadband could create hundreds of jobs for our region. The Regional Intergovernmental Council assisted Clay County in preparing a HUD Community Development broadband grant for Clay, Calhoun and Roane Counties to develop an independent broadband service for the region. The Regional Broadband Development Committee was formed from the individual county broadband groups. This committee consists of three members from each county. They are working tirelessly to bring high speed internet services to their areas.

OPPORTUNITIES

- 1. Bank Loans and Grant Opportunities for Business.** Finding grants or the right loan for a business can be difficult. Grants and banks have many requirements, rules and paperwork that can be overwhelming and frustrating. Securing funding for start-up firms based in research and innovation can be challenging because banks normally do not lend money for intangible assets. Some government and private agencies offer grant and loan funds to help small business startups or to grow existing businesses and provide a cheaper alternative to credit card rates.
- 2. Out of Country or State Investors.** The region's beauty, friendly communities and low cost of living makes the area and state an appealing place to reside and work. Its strategic location and a readily available skilled workforce are vital incentives for investors to locate here.

The region has seen some success in attracting foreign companies such as Toyota, Kureha, Gestamp and NGK sparkplugs. The WV Development Office, political leaders and development organizations have been and continue to be aggressive in pursuing these investments.

- 3. Re-employment of Idle Workforce.** With the downturn of the coal industry, many laid off workers are finding employment. With various

start-up business like the Green Mining Model Business Program and different employment training programs many employees who have lost their jobs may see opportunity on the horizon. It is important that businesses, development officials and workforce investment boards work together with community and technical colleges to assure that laid-off workers are trained for the new positions.

- 4. Shale Gas Industry.** The development of Marcellus Shale has the potential for significant economic development for our region and state. With the development of new methods for the exploration and development of unconventional reservoirs such as those found in the Marcellus Shale formation, West Virginia has seen significant increases in exploration permits since 2005. In many cases, the natural gas deposits also contain other useful by-products, including ethane. Ethane molecules can be “cracked” to create ethylene and ultimately many other chemicals. It is hoped that one or more “cracker” plants will be built in the state and that the chemical industry, particularly in the Kanawha Valley, will be revitalized.
- 5. Health Care.** The healthcare industry is projected to continue to drive the nation’s employment growth through 2026 by adding around 4 million new jobs, accounting for about a third of total job growth, according to the Bureau of Labor Statistics data released in 2017. The healthcare industry has long fueled the country’s economy. Demand is expected to pick up as the population ages, people live longer, more gain insurance coverage and chronic conditions become more prevalent.

The Kanawha Valley is a regional health care center and is positioned to take advantage of employment gains in this sector.

- 6. Startup Businesses in Technology.** The technology industry is expanding with companies like Resolver, N3 and Infor locating in the Kanawha Valley and building a strong foundation for further technology growth and opportunity in the region. Resolver, a Canadian-based technology company that specializes in business solution and risk management software products located in Charleston in 2017. N3, an international sales and marketing firm based out of Atlanta located at the West Virginia Regional Technology Park in South Charleston in 2018. And in early 2019, Infor, a global technology company that runs cloud applications for local, state and federal government agencies and government contractors supporting these agencies opened a new office at Laidley Tower in Charleston. Infor is also partnering with Marshall University and West Virginia State University to build a pipeline of skilled

talent that is trained in software engineering, cloud operations and support services related to Infor products.

Threats

1. Local Businesses Shutting Down. Business owners make difficult decisions all the time. Some businesses in our region have closed their doors because of economic conditions; low national economic growth has affected many businesses operations. The inability to generate the sufficient business profits is also a common reason for various companies in our area to close their doors. The owners spend money on inventory, production overhead and general business expenses when operating a company. Companies need economic resources to produce consumer goods and services. It is important that businesses take advantage of resources, such as the WV Small Business Development Center (WV SBDC), which may be able to provide the assistance they need to stay in business.

2. Workforce Readiness. Business leaders continue to report struggles with hiring prepared and skilled employees. At a time when the baby boom generation is approaching retirement, businesses require an exceptional pipeline of new workers to continue the American traditions of innovation and productivity. Reports from different potential employers and local development authorities identify the inability to pass a drug test as a major issue.

Challenging transportation logistics are a hurdle for many residents in the region. Inadequate public transit and car affordability are significant barriers to attaining and maintaining workforce employment. The needs of employers are rapidly changing, and training providers must be more responsive, or the state economy will suffer.

3. Lack of Capital. A small business that lacks sufficient working capital may find difficulty in attracting investors and lenders. Working capital shows investors and creditors that a company possesses the ability to pay back its loan or can earn sufficient profit that will allow investors to earn a return on their investments. The inability to attract investors and lenders affect company's ability to purchase necessary resources.

Capital has been very difficult for some businesses to acquire in the state because banks usually do not lend to start-ups, therefore, businesses struggle to find partners to provide that capital.

- 4. Opioid Epidemic.** According to the National Institute on Drug Abuse, West Virginia has one of the highest rates in the United States of non-medical use of prescription pain relievers among 19 to 25-year olds and the highest age-adjusted rate of drug overdose deaths involving opioids. In 2017, there were 833 drug overdose deaths involving opioids in West Virginia—a rate of 49.6 deaths per 100,000 persons. This is threefold higher than the national rate of 14.6 deaths per 100,000 persons.

The opioid epidemic has hit Boone County especially hard. According to a 2018 report by the American Enterprise Institute (AEI) the epidemic is costing the Boone County economy an estimated \$206.5 million a year, which is the highest per-capita burden of any county in America. Also, according to the same AEI report, Kanawha County's economy takes on a \$854 million burden each year on a total cost basis (not per-capita) from the opioid epidemic.

The opioid epidemic has crossed all socioeconomic and geographic boundaries and continues to affect the economy in our region costing employers substantial economic hardship and loss of productivity. It is often hard for companies to even find and retain qualified employees because of substance abuse issues.

Strategic Direction / Action Plan

Goals, Objectives & Development Strategies

GOAL 1:

To achieve a diversified and balanced economy within the region.

Objective:

Maintain a strong industrial base with construction of new industrial parks and expansion of existing industrial parks.

Strategy:

- Work with economic development agencies, non-profit organizations, workforce investment boards, vocational schools and community colleges to develop and advertise training programs for area residents.
- Cooperate with local agencies in developing industrial sites.
- Support manpower training programs for a skilled labor force.
- Disseminate information on market conditions and federal assistance programs to local governments and business associations.
- Assist in identifying potential industrial sites in the region.
- Promote continued development and expansion of the WV Regional Technical Park.
- Develop water, sewer, transportation and broadband infrastructure in preferred development areas and in unserved and underserved areas.

Objective:

Support the region's energy and chemical industries.

Strategy:

- Promote clean coal technology.
- Support construction of an ethane "cracker" in the region.
- Provide end use economic opportunities for mountain top removal lands.
- Promote the use of natural gas as a motor vehicle fuel.

Objective:

Promote entrepreneurship, innovation and small business growth in the region.

Strategy:

- Assist small business incubators and local non-profit economic development programs to expand local businesses.
- Support strategies and infrastructure designed to encourage high-tech start-ups in the region.
- Promote programs to increase the amount and availability of venture capital in the region.
- Encourage start-ups and existing business to utilize the services of the West Virginia Small Business Development Center.

Objective:

Support the expansion of tourism and convention business.

Strategy:

- Work with state and local trail and tourism groups to promote attractions of Region III.
- Support travel-related projects being planned for the region.
- Promote fairs, festivals and other events within the region.

Objective:

Support downtown revitalization plans and community services necessary for economic growth.

Strategy:

- Provide technical assistance to municipalities wishing to upgrade their structures and services.
- Support the development of services and facilities necessary for long-term growth.
- Assist communities in applying for USDOT Transportation grants for downtown streetscape projects.
- Promote existing programs such as the WV On-Trac / Main Street Program.

GOAL 2:

Promote international trade development.

Objective:

Increase awareness of trade resources and information available at the local, state and federal level to help WV companies take advantage of the overseas demand for U.S. products and services.

Strategy:

- Provide startup support and consultative services in the areas of businesses and marketing plans, management, international finance, global market entry and growth strategies, research and analysis, product design and development plans.
- Support technical assistance projects that provide knowledge of customers, products and competitors to better capture and maintain global market share.
- Fund incubators to commercialize regional development, patents and inventions into innovative products.

GOAL 3:

Assist coal-impacted communities.

Objective:

Assist communities and regions which have suffered losses in coal mining and related manufacturing and power plant employment.

Strategy:

- Provide assistance to development.
- Economic diversity.
- Workforce development and economic resilience in coal-dependent communities.

GOAL 4:

To achieve a diversified and balanced economy within the region.

Objective:

Support resilient communities.

Strategy:

- Review and approve mitigation guidelines.
- Provide technical assistance in mitigation requirements.
- Promote existing mitigation programs.

Objective:

Promote and develop Broadband access to all areas in the region.

Strategy:

- Provide technical assistance to all entities in the development of Broadband services.
- Assist entities in the application process of Broadband expansion.
- Promote increased bandwidth and connectivity in the region.

Evaluation Framework

Performance Measures and Outcomes

The completion of the CEDS is an important achievement for Region III because it allows our staff to evaluate the success of projects and provides the Council with a way to determine priorities and goals for the future. The Regional Intergovernmental Council evaluates the success of the CEDS with the following measurements:

1. **Number of Applications Completed:** this measurement shows the continued need of Region III's services and the projects and priorities that our local communities are wanting to complete.
2. **Number of Projects Administered by Staff** – this measurement shows the need for Region III's services in providing project administration in completing the region's priorities.
3. **Number of New Customers Served with Infrastructure (water, sewer, broadband).** This measurement reflects the number of new customers receiving water and sewer. These types of services continue to rank close to the top priorities our region identifies annually.
4. **Amount of New Jobs Created as a Result of the CEDS** –this measurement illustrates the number of new jobs created with the assistance of the Regional Intergovernmental Council.
5. **Amount of Private Sector Investment** – this measurement shows the amount of private sector dollars invested in this region as a result of the CEDS.

Economic Resilience

Economic Resilience

It is becoming increasingly apparent that the Regional Intergovernmental Council, a four-county planning and development council, consider economic prosperity is linked to an area's ability to prevent, withstand and quickly recover from major disruptions to its economic base. Establishing economic resilience in a local or regional economy requires the ability to anticipate risk, evaluate how that risk can impact key economic assets, and build a responsive capacity. Often, the shocks/disruptions to the economic base of an area or region are manifested in these ways:

- Downturns or other significant events in the coal industry which impact demand for locally produced goods and consumer spending.
- Downturns in coal related industries that constitute a critical component of the region's economic activity.
- Other external shocks such as the June 23, 2016 flood that decimated Clendenin and Clay County areas.

This is no more apparent than the downturn in the coal industry in our region. The Regional Intergovernmental Councils Comprehensive Economic Development Strategy begins to build the capacity for economic resilience. The members of this committee often become the focal point for post-incident coordination, information dissemination, responding to external inquiries, and the lead grant administrator for local, state and federally funded recovery initiatives.

In building economic resilience, it is critical that this organization consider its role in the pre-incident and post-incident environment to include proactive and responsive initiatives.

Regional Economic Analysis

Regional Economic Analysis

Statistical information of the Region's economy helps identify strengths and helps focus efforts on building on these strengths. Educational attainment, young-adult population growth, high-tech employment and other statistics are all used to calculate the Innovation Index. The resulting measurement details a region's ability to adapt in the changing economy.

The Innovation Project was sponsored by U.S. EDA to develop simple tools that provide a characterization of a local economy and can also help set the course for long-term growth in a region. The goal of these tools is to help planners assess their region's comparative strengths and weaknesses while fostering innovation-based growth.

The EDA defines industry clusters or economic clusters as geographic concentrations of competing, complementary, or interdependent firms and industries that do business with each other and/or have common needs for talent, technology and infrastructure. Firms in an economic cluster may be competitive and cooperative.

By defining and using economic clusters, firms will be able to easily see the benefits of geographic location. Firms would be able to analyze the cost of relocation when considering a new business venture. Developers, engineers and planners would be more prone to using economic clusters in large business decisions. However, small business owners would also benefit from using economic clusters.

The Regional Intergovernmental Council has utilized these tools; Innovation Index, and Industry and Occupational Clusters to develop this Regional Economic Analysis.

Regional Innovation Index

The ability of a regional economy to innovate drives healthy growth; the innovation index takes an expansive look at indicators related to innovation from input and output perspectives.

The innovation index is comprised of six measures within a region and compares those at the national or state level.

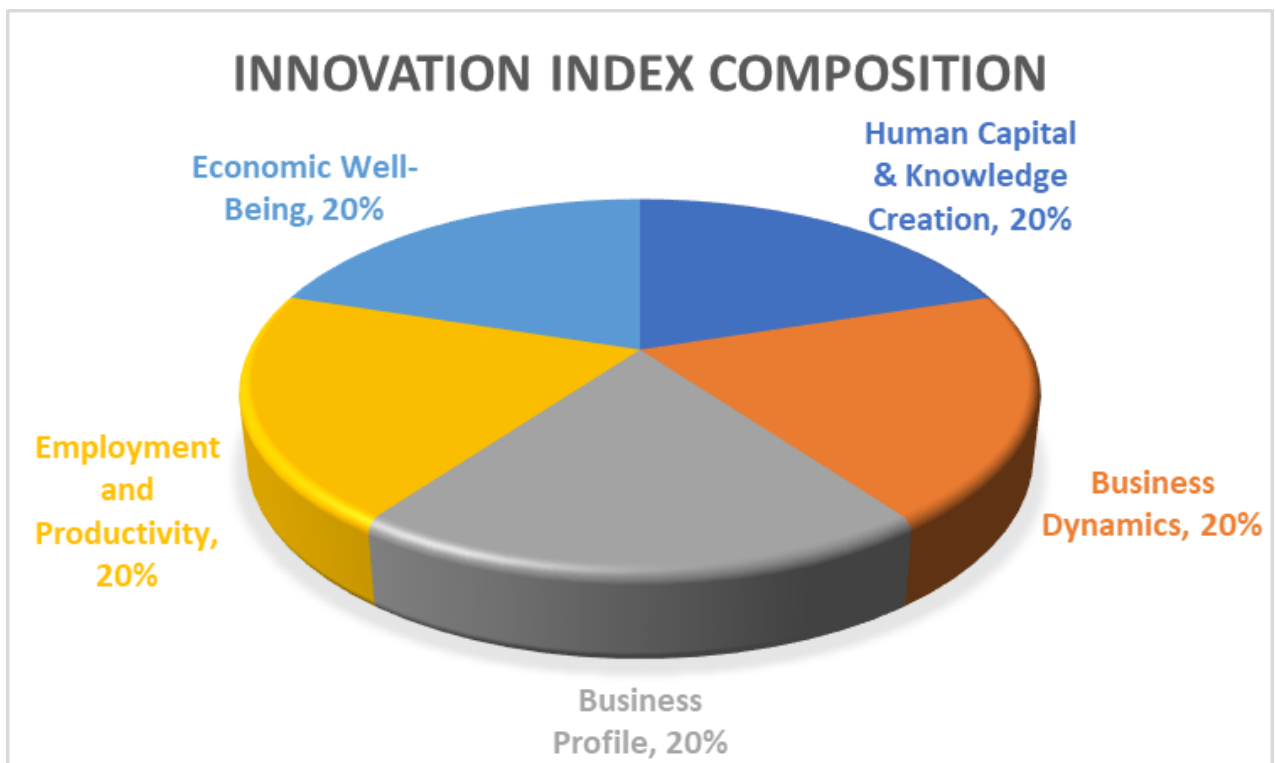

*State Context is the sixth measure but used as a reference only.

Based upon statistical analysis, several factors seem to be especially important for increasing economic growth: educational attainment; young-adult population growth; high-tech employment growth; and the number of small establishments.

The following graph illustrates the innovation index for the Region III Planning and Development Council area compared to the United States index base of 200.

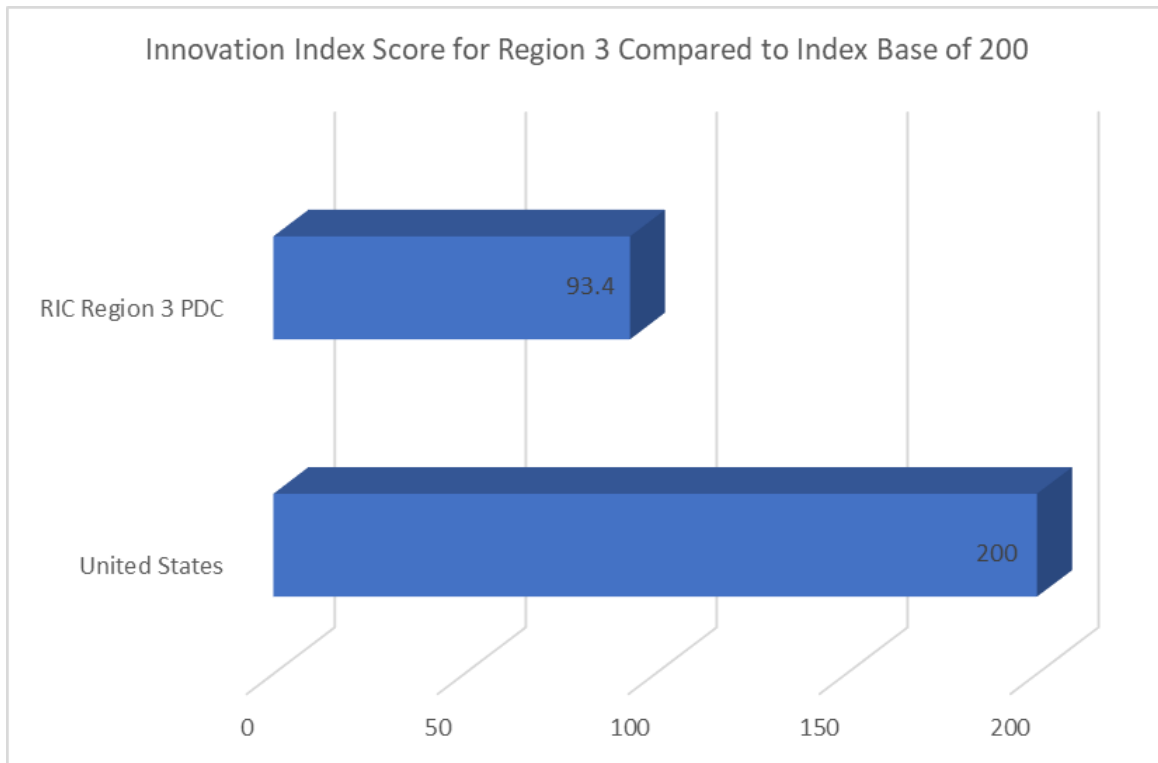

It is important to note; economies do not recognize political boundaries and each region will have a different mix of qualities that affect the overall innovation score.

The following graph and table will illustrate the individual county scores and the value of each component of the innovation index. While the Region III innovation index is 93.4, the individual county index ranges from 66.8 to 98.5.

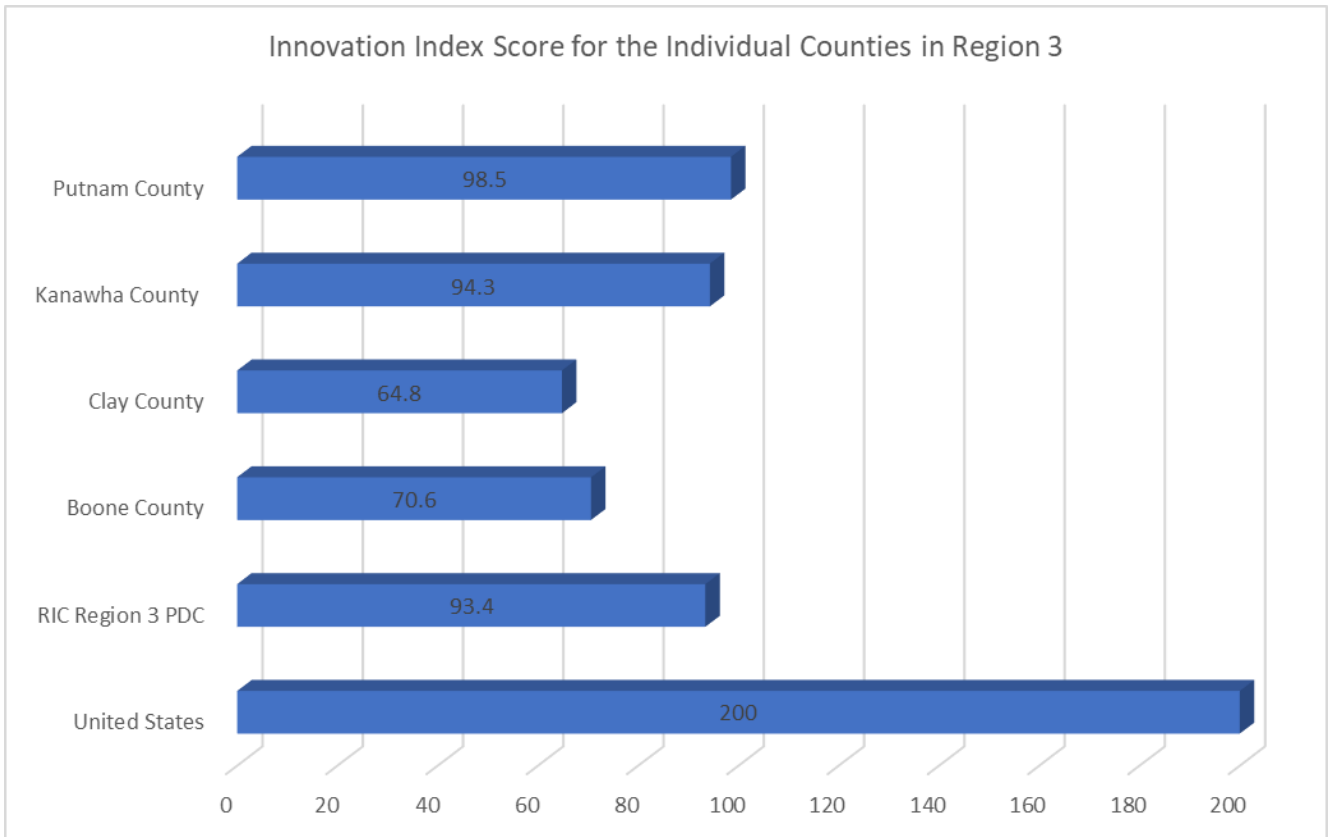

	Human Capital	Business Dynamics	Business Profile	Productivity and Employment	Economic Well-Being
Boone	65.6	29.2	68.1	94.5	96.5
Clay	54.1	51.4	82	60.8	91.1
Kanawha	104.6	73.3	102.7	93	103
Putnam	114.2	46.5	87.9	121.7	122.8

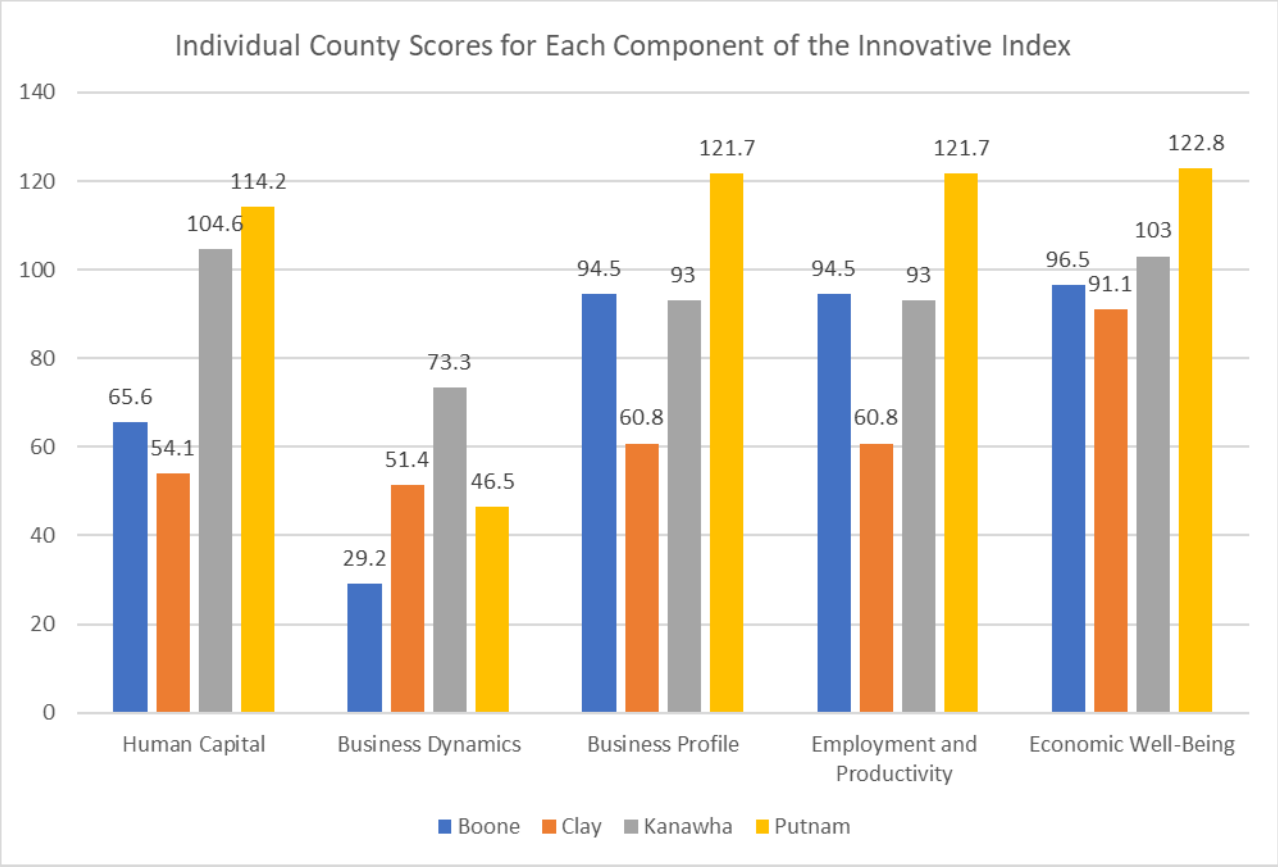

Industry Cluster Analysis

A location quotient is used to determine the relative employment within a region; a score above 1.0 indicates a higher concentration of employment in an industry than the national average. Conversely a score below 1.0 indicates a lack of employment in an industry and can indicate travel outside of the region for goods produced from a particular industry.

The following tables identify the industries within Region III and each county with a high location quotient score.

Industry	West Virginia	Region 3
Energy (Fossil & Renewable)	1.64	1.6
Chemicals & Chemical Based Products	1.05	1.16
Biomedical/Biotechnical (Life Sciences)	1.26	1.28
Transportation & Logistics	1.29	1.33
Mining	1.36	1.09

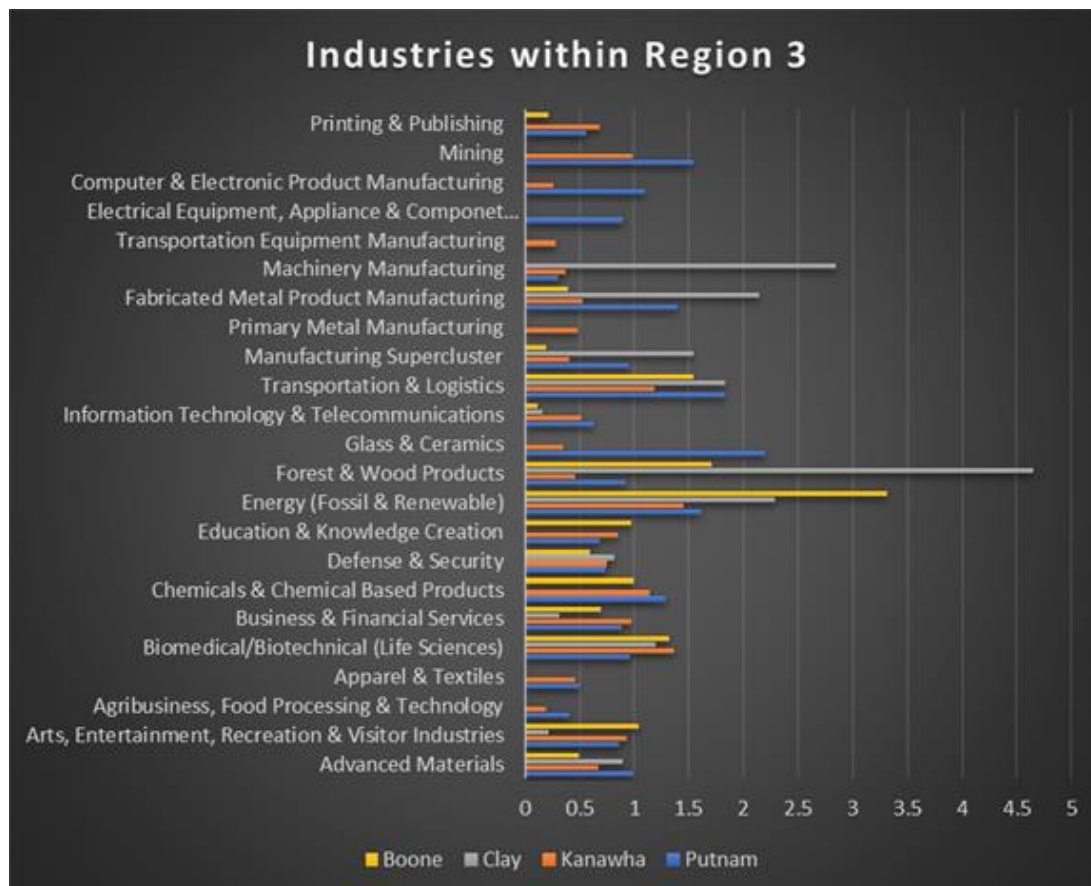

Occupational Cluster Analysis

This tool breaks down a regions workforce into 19 categories to understand what specific occupations drive the local economy and discover the potential to support innovative companies.

Occupation cluster analysis is a very new approach that focuses on the knowledge, skills and abilities of the individuals within a region. A location quotient is also utilized to identify high employment within certain occupations.

Occupation	West Virginia	Region
Agribusiness and Food Technology	1.82	0.61
Arts, Entertainment, Publishing and Broadcasting	0.61	0.62
Building, Landscape and Construction Design	0.92	1.40
Engineering and Related Sciences	0.7	0.89
Health Care and Medical Science (Aggregate)	1.26	1.30
Health Care and Medical Science (Medical Practitioners and Scientists)	1.07	1.14
Health Care and Medical Science (Medical Technicians)	1.3	1.48
Health Care and Medical Science (Therapy, Counseling and Rehabilitation)	1.32	1.29
Information Technology (IT)	0.45	0.56
Legal and Financial Services, and Real Estate (L & FIRE)	0.75	1.00
Managerial, Sales, Marketing and HR	0.74	0.85
Mathematics, Statistics, Data and Accounting	0.65	0.91
Natural Sciences and Environmental Management	1.21	1.44
Personal Services Occupations	0.85	0.79
Postsecondary Education and Knowledge Creation	0.9	0.58
Primary/Secondary and Vocational Education, Remediation & Social Services	1.04	0.82
Public Safety and Domestic Security	0.89	0.81
Skilled Production Workers: Technicians, Operators, Trades, Installers & Repairers	1.25	1.32
Technology-Based Knowledge Clusters	0.72	0.82

Occupational Employment Location Quotient

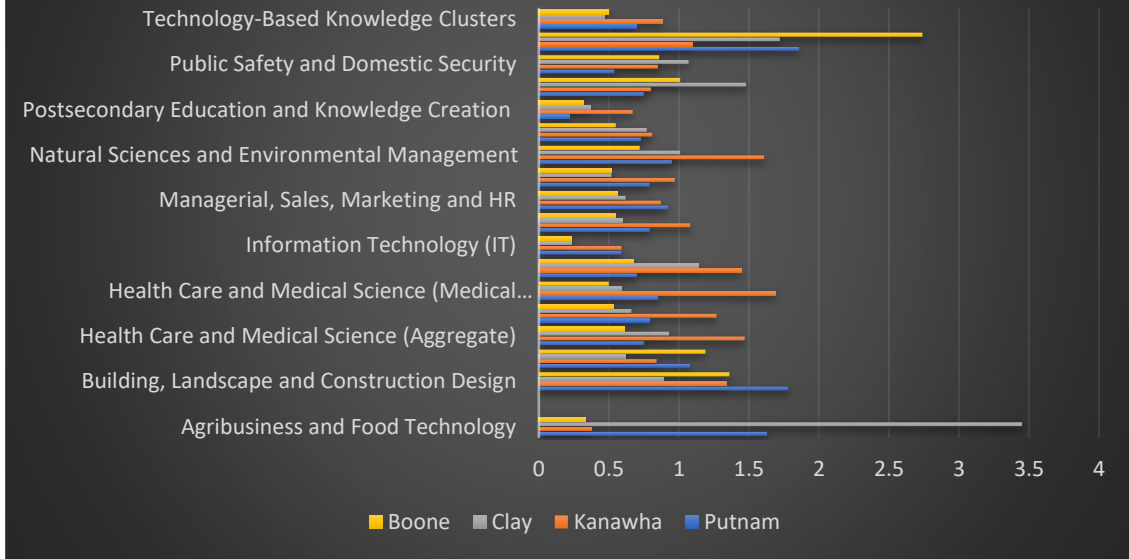

Regional & County Economic Development Initiatives Project List

Description of Program and Project Selection Process.

Region III is comprised of four counties and twenty-five municipalities. The Economic Development Initiatives Project List describes economic development activities and proposed projects within the 4-county region. Our local governments and development agencies were asked to submit their projects for the CEDS process. Our CEDS Committee then convened to review the projects.

It should be noted and recognized that since the inception of the CEDS for Region III, millions of dollars have been invested in economic development projects that are listed and tracked through this CEDS report.

The CEDS process is long and involved, seeking time and effort from many individuals and organizations throughout the community. The CEDS for the Boone, Clay, Kanawha and Putnam counties are successful due to collaboration and outreach. This report is a compilation of efforts by staff and volunteers to critique all economic development activities within the region.

Economic Development Initiatives Project List

Deer Valley Lift Station and Force Main Upgrade	Putnam	Putnam PSD	\$1,075,000
To provide sanitary sewer service to a new business - Peterbilt of Kentucky on a 75-acre plot. The company is a material storage facility for tractor trailer parts.			
West Virginia Regional Technology Park	Kanawha	WV HEPC	To Be Determined
Promote continued development and utilization of the WVRTP as a research and business park. Currently the Park is home to two Community Colleges, Matric Research Facility, TechConnect WV, Chemical Alliance Zone and a number of private companies.			
WV 601 (Jefferson Road) Improvements	Kanawha	WV DOT	\$55,000,000
This project would widen the highway to five lanes from McCorkle Avenue to US 119 (Corridor G), construct a connector road from RHL Blvd at Trace Fork Shopping Center to Jefferson Road and construct a flyover bridge over CSX mainline tracks and Kanawha Terrace.			
Slack Plaza Renovations	Kanawha	Charleston	\$8,000,000
To expand the outdoor experience from Capitol Street to Court Street including the Charleston Transit Mall, home of the Kanawha Valley Regional Transit Authority major destination. This plaza is the gateway to the Charleston Town Center, the major retail mall in downtown Charleston.			
Industrial/Commercial Park at Kanawha Manufacturing Location	Kanawha	Charleston Area Alliance and Advantage Valley	Cost undetermined
To redevelop a prime site in the middle of Charleston with road and rail service available.			
Shell Building at Putnam County Park	Putnam	PCDA	\$2,000,000
To develop a spec building that will serve either for rental or sale to increase jobs and increase the vitality of the local economy.			
Virginia Street Gateway Project	Kanawha	Charleston	\$1,500,000
To provide a gateway entrance that will assist in the appeal of the Main Business District that will attract new businesses and assist current companies to expand. This project will be the focal point from Interstate 64.			
New US 35 alignment in Putnam County	Putnam	WV DOT	\$98,400,000
This project would construct a four-lane median-divided highway between the Lower Buffalo Bridge (CR 869) to the Mason County line. This continuation of the improvements to US Route 35 would spur economic development along the roadway and increase the movement of goods to market. It would also reduce the number of fatal accidents along the two lane stretch of the current Rt 35.			
Putnam County Commercial and Business Park at Rt 35 and Rt 817	Putnam	Putnam County Development Authority	\$10,000,000

This property is located at the end of Rt 35 in Teays Valley and parallels the upscale Devonshire Subdivision. It will have approximately 33 developable acres. This property is suitable for commercial and retail businesses. There are six distinct parcels that could be developed. The Advantage Valley POWER grant is providing conceptual plans for this property and has ranked it high on their evaluation. (P6) The property is for sale

Clay County Industrial Park	Clay	CAEZ	\$5,000,000
To develop a commercial / industrial park and spec building that will serve either for rental or sale to increase jobs and increase the vitality of the local economy. Clay county has lost much of its tax base and ancillary businesses because of the closure of Fola (Consolidation) Coal. The area needs to see a revitalization of their job base to sustain their economy.			
South Charleston TIF Industrial/Commercial Park	Kanawha	City of South Charleston	\$50 to \$100 million
To develop a commercial / industrial park along MacCorkle by filling the fly ash pond with fill from the Jefferson Road widening project. The City is providing funds for the road expansion and hopes to develop many economic development areas in the TIF area.			
Inland River Port at Eleanor, WV	Putnam	PCDA	\$4,000,000
To develop a public river port near the Winfield lock and dam system. This port would move and store products from the Ohio and Kanawha rivers to the new U. S. Route 35 which begins in Teays Valley and continues northwesterly into Central and Northwestern Ohio. It would also connect to Interstate 64 and I-77/79 to access most of the Northeast			
Kanawha County Industrial Park	Kanawha	CAA	To Be Determined
Determine a location and develop an industrial park. The Land Task Force has identified a few possible sites and are evaluating the scope and cost of site development			
Yeager Airport Aerospace Business Park	Kanawha, Boone, Putnam, Lincoln and Nicholas Counties	Yeager Airport	\$23,000,000
Build and Aerospace Business Park by utilizing 25 Acres of Available Flat Land for Shovel Ready Aviation Projects – Eagle Mountain Road will be extended around General Aviation to connect with the Air National Guard base.			
East End Industrial - Commercial Business Park	Kanawha	Charleston Area Alliance	\$8,800,000
To provide an Industrial / Business Park at the former Kanawha Manufacturing site in the East End of Charleston. The property is in excess of 5 acres has road and rail service and is very close to interstate ramp access. The Advantage Valley POWER grant to locate available sites has placed this very high on their priority list and provided a conceptual rendition of the property. (K20) The owners are willing to sell.			

Charleston Riverfront Development	Kanawha	Charleston	To Be Determined
Promote the Kanawha Boulevard Area as a premier location for a riverscape area for businesses to locate. This will consist of residential, retail and commercial locations along the Kanawha Boulevard from Haddad Riverfront Park to the Elk River.			
Improvements to US 60 in Kanawha County	Kanawha	WV DOT	\$31,300,000
This project would widen to a four-lane divided facility from the Admiral TJ Lopez Bridge (Chelyan Bridge) to CR 81 (Kellys Creek Road). This widening of US Route 60 would enhance the ability for business to grow and prosper in the Upper Kanawha Valley, an area affected by the loss of coal and coal-related employment.			
Workforce CCE (Construction, Telecommunications and Energy) Training Center in Montgomery	Kanawha and Fayette	BridgeValley CTC	\$1,500,000
To add telecommunications option to the Utility Line Service program. Expand energy and electricity to the ATC Center.			
Third Street Underpass Improvements in Saint Albans, WV	Kanawha	St Albans	\$9,600,000
Widen the existing railroad underpass to three lanes and improve vertical clearance. This will open the City to a free-flowing access to the main section of the City. There are many commercial and retail sites available for expansion in the city core.			
Putnam County Industrial Park at Route 35 and Route 34	Putnam	Putnam County Development Authority	\$3,000,000
This property is located at the exit of Rt 34 (Winfield Rd) on Rt 35. This property was leveled and contoured as a result of the construction of the new Rt 35 roadway and would support an approximately 100,000 sq. foot industrial or commercial facility and parking on the upper shelf. Possible retail or commercial enterprises could be located near the Rt 34 roadway. The Advantage Valley prepared a conceptual plans for the upper level. (P11). The property owner is willing to negotiate.			
West Washington Streetscape	Kanawha	WV DOT	\$5,000,000
To provide a gateway entrance that will assist in the appeal of the West Side and help the West Side Main Street Association attract new businesses and assist current companies to expand. This complex street scape should be separated into six phases and would provide construction jobs and attract investment.			
Projects for WV Biosciences Association	Kanawha	WV HEPC	To Be Determined
Any project that envisions biosciences that create jobs and helps the local economy.			
CCR Broadband Implementation Project	Clay, Calhoun and Roane	Clay, Calhoun and Roane Counties	\$10,000,000

To develop an open access network that provides a minimum of 25 mgb of download speed and 4 mgb of upload speed to all businesses, schools, medical facilities and residences in the three-county area.			
Coal Related Job Retraining	All	Workforce	To Be Determined
To develop retraining or assist new businesses that will diversify the coal related economy.			
Montgomery Technology Incubator Rehabilitation Project	Kanawha	UKEVC	To Be Determined
To provide Guidance to develop Montgomery Technology Incubator as a viable entity			
WV Defense Contractor Supply Chain Study	All	St of WV	To Be Determined
To study companies that are providing defense contract supply that could be redirected into other areas of Manufacturing and other industries.			
Rare Earth Elements Project	All	Higher Education Policy Commission	To Be Determined
Rare earth elements are a set of seventeen chemical elements in the periodic table, specifically the fifteen lanthanides plus scandium and yttrium. They are the elements that have become irreplaceable to our world of technology owing to their unique magnetic, phosphorescent, and catalytic properties.			
Phase II Green Mining Lavender and Pyrethria cultivation project on mountaintop mined lands	Kanawha	WV Tech Park Corp	\$5,000,000
To continue to develop land and train displaced miners and for a cooperative to market the oils and distill the plants. The WVTPC and Prichard Mining are developing additional locations in Kanawha and possibly Boone counties.			
West Virginia Entrepreneurship, Commercialization and Investment Alliance (WV-ECIA)	40 counties Including Boone, Clay, Kanawha and Putnam Counties	WV High Tech Foundation, WV Jobs Investment Trust and TechConnect WV	\$500,000
The goal of this initiative is to expand economic opportunity by creating a fully functional entrepreneurial ecosystem, with the capacity to facilitate commercialization, early stage investment, business education, and opportunities			
Water and Sewer Projects to Industrial/Commercial Parks	All	Any Utility	To Be Determined
Any project that will assist commercial or industrial businesses compete in the local, regional and global markets.			
Rock Creek Industrial Park (Former Hobet Mining) Road Phase	Boone County	WV Development Authority & WV National Guard	\$30,000,000

To develop a road system and new interchange to the Industrial, Commercial park on thousands of acres in Boone and Lincoln Counties. To use as a training facility for the National Guard. To work with alternative fuels and Rare Earth Elements studies.			
Rock Creek Industrial Park (Former Hobet Mining) Development Project	Boone County	WV Development Authority & WV National Guard	\$30,000,000
To develop the Industrial, Commercial park on thousands of acres in Boone and Lincoln Counties. To use as a training facility for the National Guard. To work with alternative fuels and Rare Earth Elements studies.			
Rock Creek Industrial Park (Former Hobet Mining) Infrastructure Phase	Boone County	WV Development Authority & Boone County PSD	\$3,700,000
To develop a water line for potable water to the Industrial, Commercial park on thousands of acres in Boone and Lincoln Counties. To use as a training facility for the National Guard. To work with alternative fuels and Rare Earth Elements studies.			
Rimfire ATV Trail System	Clay as part of a 14-county trail system	WV Central ATV Trail Consortium	To Be Determined
To develop an all-terrain vehicle system comparable to the Hatfield and McCoy Trail System for central WV..			

Planning Initiatives			
Technical Assistance for TECHWRK WV	Kanawha	TechConnectWV	\$625,000
Nitro Brownfields Redevelopment Assessment	Putnam	PCDA	\$200,000
Coonskin Park Bridge Economic Development Planning Grant	Kanawha	CAA	\$500,000

Note: acronyms	
Boone County Economic Development Authority	BCEDA
Charleston Area Alliance	CAA
Central Appalachia Enterprise Zone	CAEZ
Putnam County Development Authority	PCDA
WV Department of Transportation	WV DOT
WV Higher Education Policy Commission	WV HEPC
Upper Kanawha Valley Enterprise Community	UKVEC

RIC Progress Report

Local Technical Assistance

The Council's staff was involved in various stages of projects, including;

- Provided grant administration to ten or more local governments having HUD, EPA, USDA, US Army Corps of Engineer 571 and ARC grants, as well as State agency grants. This is an important service offered by RIC to keep local governments in compliance with federal regulations and audits.
- Disseminated information on State and Federal development programs to all local governments in the RIC region. Worked with local officials in developing projects.
- Served on various committees and boards, including the Putnam County Transportation Committee, CCR Regional Broadband Committee, the Greater Kanawha Valley Foundation Economic Development Committee, the Kanawha Coal Reliant Communities Group, the Community Reinvestment Act Committee, the WV Association of Regional Planning and Development Councils, and the WV Association of Metropolitan Planning Organizations.
- Assisted communities and others by providing GIS mapping and other technical services. Provided information regarding various government programs and advised communities in dealing with various technical and administrative issues.
- Assisted the City of Madison, the Town of Sylvester and the Boone County Commission by providing technical assistance to develop outdoor recreation projects to be considered for Department of Interior Land and Water Conservation Grants.
- Assist the Boone Raleigh Public Service District in re-evaluating their water and sanitary sewer system and reconfiguring their District Board.
- Provided census and other data to local governments, communities, and others.

- Assisted local water providers in development source-water assessment and protection plans.
- Assisted communities in Boone and Clay counties with initiating Broadband Cooperatives and applying for needed funding.

Community and Economic Development

- RIC administered a number of infrastructure projects, including: Boone County PSD Sewer Project; Boone County Morrisvale/Cameo Waterline Extension Project; Boone County Prenter II waterline Extension; Boone County Right Fork Waterline Extension, Clay County Pack Fork and Independence Road Waterline Extension Project; Clay County Big Otter/Nebo/Tanner Hollow Waterline Extension, Town of Clay Blue Knob Waterline Extension; Putnam County Manila Ridge waterline extension; Clay-Roane PSD Waterline Extension Project; and Belle Sewer Rehabilitation Project.
- RIC is assisting in the development of additional infrastructure projects, including: Nitro Regional Wastewater Treatment Improvements; the Boone County/Madison Sewer Rehabilitation Project; the Kanawha PSD Sewer Extension Project, the Elk Valley PSD Sewer Extension Project, the Clay County PSD Interconnection project, Town of Clay Water Tank Replacement, Town of Clay Wastewater Improvements and Cedar Grove Sewer Project. RIC also assisted with funding requests for many other projects, some of which are pending.
- RIC also continued to administer a U.S. EDA planning grant to TechConnect WV.
- RIC prepared three (3) newsletters and one Annual Report.
- Attended the WV Association of Regional Planning and Development Councils Annual Conference.
- Assisted Central Appalachia Empowerment Zone in developing an application for a technology center broadband grant from ARC.
- Completed five HUD Small Cities Block Grant Applications
- Participated in numerous trainings on the POWER+ Program and the Broadband Infrastructure Program through the WV Broadband Committee.

- Assisted TechConnect WV with an EDA economic adjustment application for their new Next Up WV project.

Private Development

- Completed and submitted annual CEDS Update.
- Provided information on Region III to consultants, market analysts and private businesses to promote economic development.
- Provided information for an EDA grant for TechConnect WV.
- Assisted the WV Tech Park with developing a continuation application for the Green Mining Model Business Plan project
- RIC has assisted the State with broadband development efforts, including reviewing applications for technical assistance grants and preparing a regional broadband strategic plan.
- Assisting the Putnam Public Service District to upgrade their force Main Lines and Pump Station to accommodate new development of a large commercial user.
- Assisting in the development of a waterline to the Rock Creek Business Park (formerly the Hobet Complex) in Boone County to foster business expansion and creation in the Boone County Region.

Transportation Planning

Metropolitan Transportation Plan

The primary focus of RIC's transportation planning efforts and resources in 2017 was on producing an update to RIC's Metropolitan Transportation Plan (MTP), which encompasses the entirety of Kanawha and Putnam counties. This multimodal planning effort took a fresh look at the region's transportation system and identified deficiencies in the region's highway, public transit, bicycle and pedestrian transportation systems and developed recommendations for improvements.

RIC's MTP is updated on a four-year cycle, the current MTP was originally adopted by the RIC Policy board on September 7, 2017. Early in 2018, a

decision was issued from a court case (*South Coast Air Quality Management District v. EPA*), which directly impacted national air quality conformity requirements for transportation planning. Effective February 16, 2018, areas that were previously designated as “nonattainment” or “maintenance” under the 1997 8-hour ozone National Ambient Air Quality Standards (NAAQS), are required to demonstrate transportation conformity through a detailed process which includes the performance of a quantitative transportation conformity analysis. RIC’s metropolitan transportation planning area (Kanawha and Putnam counties) did not meet the 1997 8-hour ozone NAAQS and is designated as a maintenance area by the EPA. RIC coordinated with Federal, State and local agencies to conduct the required transportation conformity analysis for the purpose of evaluating transportation conformity for all projects in the FY 2018-2021 TIP and current MTP. The analysis report, completed in August 2018, required additional demographic and traffic forecasting, travel demand model analysis, and the development of an air quality model. The findings of the analysis demonstrate transportation conformity for all projects under the 1997 8-hour ozone NAAQS. The RIC MTP was amended and approved on September 13, 2018 by the RIC Policy Board.

Transit Planning

RIC continues to provide transit planning services to the region’s public transportation authority, Kanawha Valley Regional Transportation Authority (KVRTA), and all organizations that provide paratransit services. Each year, RIC prepares a route level service analysis, including performance measures and performance indicators for KVRTA. Additionally, RIC organizes and hosts public informational meetings throughout the year for KVRTA in various parts of Kanawha County.

Transportation Improvement Program

RIC transportation planning staff amended the FY 2018 – 2021 Transportation Improvement Program (TIP) through approved revision requests and project amendments by the RIC Policy Board on a quarterly basis.

Census Management Planning

During 2018, RIC continued to maintain its census library of printed and digital

data materials. RIC responded to census requests from officials, agencies and the public as part of its Affiliate Data Center program.

Hazard Mitigation Planning

During 2018, RIC completed the annual update to the Region 3 Regional Hazard Mitigation Plan which encompasses all hazards impacting Boone, Clay, Kanawha and Putnam counties. Mitigation plans such as these, increase education and identify implementation approaches focused on the most vulnerable populations to improve a community's resiliency. An approved hazard mitigation plan is required to receive non-emergency disaster assistance, creating the necessity that all communities pass a resolution for plan approval.

Transportation Database/Geographic Information (GIS)

RIC continued expansion with Geographic Information System (GIS) capabilities in 2018 through the acquisition of additional GIS data and GIS software upgrades. RIC continues to utilize GIS technologies in most of its transportation planning endeavors, and to provide mapping for our Community Development activities as well as for RIC members and other regional agencies.

Bicycle and Pedestrian Initiatives

In conjunction with HDR, Inc., RIC's transportation planning staff spent the majority of 2018 working on an update to RIC's *Kanawha-Putnam Bicycle and Pedestrian Plan*. This is the first update to the original plan which was developed in 2008.

The plan update began with an analysis of regional data, existing plans and public input. Community outreach and public engagement took place in the form of targeting community groups, city and county officials, and bicycle advocacy groups. Following a strategic prioritization process, a list of proposed bicycle and pedestrian improvement projects and recommendations for Kanawha and Putnam counties was developed. The final list of improvement projects and recommendations, including potential funding sources will be included in the final planning document. The estimated completion time for the *Kanawha-Putnam Bicycle and Pedestrian Plan* is early 2019.

RIC Title VI Plan

RIC's Title VI Plan was first adopted by the RIC Policy Board in June 2016 and mandates that RIC's transportation planning program and activities abide by the requirements of Title VI of the federal Civil Rights Act of 1964, as well as subsequent acts and executive orders which fall under the umbrella of Title VI. The RIC transportation planning staff review the plan annually to ensure compliance with current and future legislation. The plan provides specific guidelines and policies for RIC to adhere to in regard to Title VI. The goal of the plan is to guarantee that federally funded transportation planning activities do not discriminate against any person or group of people on the basis of race, religion, sex, national origin, ethnicity, age, disability, political affiliation, color, marital status, sexual orientation, economic status, or any other characteristic protected by law.

RIC Public Participation Plan

RIC's Public Participation Plan was first adopted by the RIC Policy Board in December 2016 and describes the strategies, techniques and activities that RIC employs to inform and engage the public in transportation planning issues for the purpose of maximizing public involvement. This plan documents RIC's current and future actions to efficiently promote public participation through various types of activities appropriate to the scope and nature of the planning activity. Additionally, this plan outlines RIC's goals and objectives to ensure successful public participation processes for all planning purposes and activities. A significant area of importance in this plan is the ongoing focus to ensure inclusiveness in all outreach efforts to traditionally underserved populations, including limited English proficient (LEP) persons, low-literacy persons, persons with disabilities, minorities, and low-income individuals. RIC's Public Participation Plan is a living document and is reviewed annually.

RIC Congestion Management Plan

In 2016, RIC transportation planning staff began developing a Congestion Management Plan (CMP) and process for RIC's metropolitan planning area. The

CMP was the first of its kind and is a requirement for MPOs that have planning jurisdiction within a Transportation Management Area (TMA). The plan seeks to identify highway segments which regularly experience above average travel times. Actual vehicle travel time data for the region is being used to identify these segments. Public input was also solicited for determining high-congestion areas. Short-term and long-term solutions will be developed for the purpose of alleviating traffic congestion on identified high-congestion segments.

Originating as a suggestion from the Congestion Management Plan (CMP), a System Performance Report for RIC's transportation planning jurisdiction was started in 2018. The System Performance Report reflects the integration of the national performance goals set by the current Federal transportation legislation, Moving Ahead for Progress in the 21st Century (MAP-21) Act, and the Fixing America's Surface Transportation (FAST) Act. The report will be updated on an annual basis, to be utilized in assessing the efficiency of the existing transportation system located in RIC's transportation planning jurisdiction. MPOs are required to coordinate with State DOTs and transit providers to establish and integrate performance targets into their planning documents. RIC's System Performance Report will detail all performance measures and targets adopted by the state of West Virginia, RIC and KVRTA for the purposes of documenting progress and performance expectations for future planning efforts.

APPENDIX

**Regional Intergovernmental Council
FY 2019 – 2023 Comprehensive Economic Development
Strategy (CEDS) Committee Meeting**

315 D Street, South Charleston, WV 26303

April 25, 2019

1:30 p.m.

MINUTES

Attending:

Kim Reed, Nitro Development Authority
Connie Kinder, Clay County Commission
Tim Hanna, Putnam County Commission
Kris Mitchell, Boone County Development Authority
Chris Ferro, Charleston Area Alliance
D. Anne Cavalier, Cavalier Business Development
Terry Martin, Regional Intergovernmental Council
Joanna Keller, Regional Intergovernmental Council

The meeting was called to order by Terry Martin of the RIC staff.

I. Annual Hazard Mitigation Review

Terry Martin reviewed the Region 3 Hazard Mitigation Plan including the current Mitigation Strategies and Risk Assessments included in the Hazard Mitigation Plan. He asked if there were comments or questions and advised the committee members to submit any suggestions or changes to Kara Greathouse.

II. Review Goals and Objectives

Terry Martin referred the committee members to the Goals, Objectives and Strategies which had been mailed and were also distributed. These were the same goals, objectives and strategies that were included in last year's CEDS, with the addition of one goal: To achieve a diversified and balanced economy within the region, which includes objectives to support resilient communities and promote and develop broadband access to all areas in the region. He asked if there were comments or suggested changes. Discussion ensued. There were no additional changes suggested.

III. Review and Update SWOC Analysis

Terry Martin reviewed the SWOC Analysis from the 2014-2018 CEDS for additions, subtractions and changes to be included in the 2019-2023 CEDS. General discussion ensued. Multiple updates were recommended for the education section as well as several verbiage changes within the SWOC.

IV. Review of Current Proposed Investments

Terry Martin presented the Economic Development Initiatives list for the committee's consideration. General discussion of the investments ensued as well as discussion regarding the purpose of the list, which is twofold: 1) to include projects that may be considered for US EDA funding (projects must be on the CEDS to be eligible for US EDA funds); and 2) to identify economic development projects that may be funded by non-EDA funding, thereby providing a planning basis for these projects. The list was derived from last year's CEDS as well as input from local governments and economic development agencies. No investments were deducted from the current list.

V. Addition of New Investments

The following projects will be added to the Economic Development Initiatives: Deer Valley Lift Station and Force Main Upgrade, Industrial/Commercial Park at Kanawha Manufacturing Location, break Rock Creek Industrial Park into three sections and the Hatfield-McCoy Trails.

VI. Adjourn

The meeting adjourned at 2:10 p.m.

Sources:

Charleston Gazette-Mail

Coal Valley News

Herald Dispatch

Montgomery Herald

Boone County Development Authority

Putnam County Development Authority

TechConnectWV

Clay County Free Press

Workforce WV

West Virginia Division of Culture and History

WV MetroNews

STATS America

United States Census Bureau

West Virginia Department of Commerce

